

The Annual Quality Assurance Report (AQAR) of the IQAC
June 2016 May 2017

**Maharaja's College
Mysuru**



Part – A

1. Details of the Institution

1.1 Name of the Institution

Maharaja's College

1.2 Address Line 1

J.L.B Road

Address Line 2

University of Mysore

City/Town

Mysuru

State

Karnataka

Pin Code

570005

Institution e-mail address

principalmcm1837@gmail.com

Contact Nos.

0821-2419 354 / 279

Name of the Head of the Institution:

Dr. B. Nagaraja Murthy, Dr. R. Ganesh, Dr.K.
Kalachanne Gowda and
Prof. Sunitha C.P.

Tel. No. with STD Code:

0821-2419354 / 279

Mobile:

98454 00061

Name of the IQAC Co-ordinator:

Anita Vimla Braggs

Mobile:

98805 46829

IQAC e-mail address:

iqacmcm2015@gmail.com

1.3 NAAC Track ID

: KACOGN10130

1.4 Website address:

maharajas.uni-mysore.ac.in

Web-link of the AQAR:

<http://maharajas.uni-mysore.ac.in/content/aqar-2016-17>

1.5 Accreditation Details

Sl. No.	Cycle	Grade	CGPA	Year of Accreditation	Validity Period
1	1 st Cycle	4 (****)	73.15	2001	5 years
2	2 nd Cycle	-	-	-	-
3	3 rd Cycle	-	-	-	-
4	4 th Cycle	-	-	-	-

1.6 Date of Establishment of IQAC :

DD/MM/YYYY

02/08/2014

1.7 AQAR for the year (*for example 2010-11*)

2016-2017

1.8 Details of the previous year's AQAR submitted to NAAC after the latest Assessment and Accreditation by NAAC AQAR : NA (DD/MM/YYYY)

- i. AQAR: NA (DD/MM/YYYY)
- ii. AQAR: NA (DD/MM/YYYY)
- iii. AQAR: NA (DD/MM/YYYY)

University with Potential for Excellence	No	UGC-CPE	No
DST Star Scheme	No	UGC-CE	No
UGC-Special Assistance Programme	No	DST-FIST	No
UGC-Innovative PG programmes	No	Any other (<i>Specify</i>)	No
UGC-COP Programmes	-		

2. IQAC Composition and Activities

2.1 No. of Teachers	13
2.2 No. of Administrative/Technical staff	02
2.3 No. of students	Nil
2.4 No. of Management representatives	Nil
2.5 No. of Alumni	Nil
2.6 No. of any other stakeholder and Community representatives	Nil
2.7 No. of Employers/ Industrialists	Nil
2.8 No. of other External Experts	Nil
2.9 Total No. of members	15
2.10 No. of IQAC meetings held	04
2.11 No. of meetings with various stakeholders:	No. 09 Faculty 02
Non-Teaching Staff 01 teaching Staff 02 Students 02 Alumni 02 Others	

2.12 Has IQAC received any funding from UGC during the year? Yes

If yes, mention the amount

NA

2.13 Seminars and Conferences (only quality related): Nil

(i) No. of Seminars/Conferences/ Workshops/Symposia organized by the IQAC

Total Nos. International National State Institution Level

(ii) Themes

-

2.14 Significant Activities and contributions made by IQAC

- Organized an awareness talk on Women Issues by Prof. Shailaja, Dept. Of English, Govt. First Grade College, Nanjangud
- Lead actor of the movie Bettada Jeeva Mrs Rameshvari Verma interacted with the students on the literary work of Jnanapeetha Awardee Dr. Shivarama Karanth's Bettada Jeeva
- Organized Essay Competitions for students on Safety of Women in Contemporary Society and Institutional Measures for the Safety of women
- Celebrated International Human Rights Day on 19.01.2017, with a special talk on Violation of Human Rights

2.15 Plan of Action by IQAC/Outcome

The plan of action chalked out by the IQAC in the beginning of the year towards quality enhancement and the outcome achieved by the end of the year *

Plan of Action	Achievements
<p>Planned to organize seminars, workshops and conferences</p> <p>To hold Special talks to create awareness on various issues</p>	<p>1. On 14-08-2016, twenty volunteers participated in the <i>Tiranga Yatra</i> under the guidance of NSS officers. The outcome of this was to rejuvenate the patriotic feeling among the students</p> <p>-----</p> <p>1. '<i>Human rights</i>', a special lecture prof. Suresh, J S S Law College, Mysuru</p> <p>2. <i>Puppetry</i> by Folklore Department</p> <p>3. <i>Interactive meet</i> with Mr. K.B.Ganapathy, Editor, Star of Mysore</p> <p>-----</p>
<p>Exhibitions, fests and competitions to be organized</p>	<p>1. On 19th April, 2017, The Department of History organized <i>Achuth Rao's Centenary Memorial Lectures</i></p> <p>2. From 11th April 2017 to 20th April 2017, organized <i>Picture is a Thousand Words</i> a curriculum based poster exhibition on English language text</p> <p>3. Collage competition on the <i>safety of women</i></p>

* Attach the Academic Calendar of the year as Annexure.

2.15 Whether the AQAR was placed in statutory body Yes No

Management NA Syndicate NA any other body NA

Provide the details of the action taken

NA

Part – B

Criterion – I

1. Curricular Aspects

1.1 Details about Academic Programmes

Level of the Programme	Number of existing Programmes	Number of programmes added during the year	Number of self-financing programmes	Number of value added / Career Oriented programmes
PhD	17	-	-	-
PG	02	01	-	-
UG	03	-	-	-
PG Diploma	-	-	-	-
Advanced Diploma	-	-	-	-
Diploma	-	-	-	-
Certificate	-	-	-	-
Others	-	-	-	-
Total	22	-	-	-
Interdisciplinary	02	-	-	-
Innovative	-	-	-	-

(Ref: <http://maharajas.uni-mysore.ac.in/sites/default/files/courses-offered.PDF>)

1.2 (i) Flexibility of the Curriculum: CBCS/Core/Elective option / Open options

(ii) Pattern of programmes:

Pattern	Number of programmes
Semester	05
Trimester	-
Annual	-

1.3 Feedback from stakeholders* Alumni Parents Employers Students
(On all aspects)

Mode of feedback : Online Manual Co-operating schools (for PEI)

*Please provide an analysis of the feedback in the Annexure

1.4 Whether there is any revision/update of regulation or syllabi, if yes, mention their salient aspects.

- Periodic Revision in accordance with University of Mysore

1.5 Any new Department/Centre introduced during the year. If yes, give details.

<ul style="list-style-type: none"> MA in International Relations

Criterion – II

2. Teaching, Learning and Evaluation

2.1 Total No. of permanent faculty

Total	Asst. Professors	Associate Professors	Professors
59	34	35	-

2.2 No. of permanent faculty with Ph.D.

53

2.3 No. of Faculty Positions Recruited (R) and Vacant (V) during the year

Asst. Professors		Associate Professors		Professors		Others		Total	
R	V	R	V	R	V	R	V	R	V
Nil	-	Nil	-	Nil	-	Nil	-	-	36

2.4 No. of Guest and Visiting faculty and Temporary faculty

102	04	-
-----	----	---

2.5 Faculty participation in conferences and symposia:

No. of Faculty	International level	National level	State level
Attended	7	39	36
Seminars/ Presented papers	11	19	36
Resource Persons	3	15	5

2.6 Innovative processes adopted by the institution in Teaching and Learning:

- The staff and students have been provided with 24X7 Wi-Fi for technology access to improve their academic credentials
- Overhead projectors/LCD projectors in few classrooms
- Internet Resource Centre and computer laboratories
- Presentations/videos are regularly being used apart from regular conventional black board teaching by few faculty
- Project work, internship, fieldwork and study tours form part of UG and PG curricula
- Students are encouraged to participate in National and International seminars and conferences and present their work
- Curriculum based poster exhibitions on English Language texts displayed
- Live telecast of Union budget followed by analysis

2.7 Total NO. of actual teaching days during this academic year 193

2.8 Examination/ Evaluation Reforms initiated by the Institution (for example: Open Book Examination, Bar Coding, Double Valuation, Photocopy, Online Multiple Choice Questions) NA

2.9 No. of faculty members involved in curriculum restructuring/revision/syllabus development as member of Board of Study/Faculty/Curriculum Development workshop.

BOS-22	Faculty/curriculum development workshops -Nil
--------	---

2.10 Average percentage of attendance of students 75%

2.11 Course/Programme wise distribution of pass percentage:

Title of the Programme	Total no. of students appeared	Division				
		Distinction %	I % 1 st Class	II % 2 nd Class	III % 3 rd Class	Pass % Total
BA	554	1.08%	23.82%	14.25%	0.18%	39.35%
BBA	124	0.80%	17.74%	12.90%	00	31.45%
B.Com.	241	11.61%	58.09%	7.46%	00	77.18%
MSC in Criminology and Forensic Science	12	8.3%	83.3%	-	-	91.6%

2.12 How does IQAC Contribute/Monitor/Evaluate the Teaching & Learning processes:

- Centralized IA Time Table for UG Courses accommodating 22 Departments that include 147 papers spaced out in 6 days
- IQAC encourages teachers to accompany their students to get the first-hand knowledge of various topics of their curricula
- Currently we follow the University pattern of 20:80 ratios; where 20 is IA and 80 End of Semester Exam

2.13 Initiatives undertaken towards faculty development

<i>Faculty / Staff Development Programmes</i>	<i>Number of faculty benefitted</i>
Refresher courses	06
UGC – Faculty Improvement Programme	-
HRD programmes	-
Orientation programmes	-
Faculty exchange programme	-
Staff training conducted by the university	-
Staff training conducted by other institutions	-
Summer / Winter schools, Workshops, etc.	-
Others . Ph.D course work	-

2.14 Details of Administrative and Technical staff

Category	Number of Permanent Employees	Number of Vacant Positions	Number of permanent positions filled during the Year	Number of positions filled temporarily
Administrative Staff	29	-	-	11
Technical Staff	01	-	-	-

Criterion – III

3. Research, Consultancy and Extension

3.1 Initiatives of the IQAC in Sensitizing/Promoting Research Climate in the institution

- Few teachers apply for projects funded by UGC/UOM/State
- Our College being a Research Centre has 38 recognized guides.
- Course work for research scholars in Kannada, Folklore, Criminology and Geography is conducted in the campus.
- The College sanctions OOD facilities and encourages faculty to present papers at National and International Conferences.

3.2 Details regarding major projects

	Completed	Ongoing	Sanctioned	Submitted
Number	01	00	01	00
Outlay in Rs. Lakhs	6,00,000.00	-	-	-

3.3 Details regarding minor projects

	Completed	Ongoing	Sanctioned	Submitted
Number	Nil	-	-	-
Outlay in Rs. Lakhs	-	-	-	-

3.4 Details on research publications

	International	National	Others
Peer Review Journals	06	05	-
Non-Peer Review Journals	12	11	-
e-Journals	06	-	-
Conference proceedings	-	-	-

3.5 Details on Impact factor of publications:

Range Average h-index Nos. in SCOPUS

3.6 Research funds sanctioned and received from various funding agencies, industry and other organisations

Nature of the Project	Duration Year	Name of the funding Agency	Total grant sanctioned	Received
Major projects	2015-2018	UGC	Rs.6,10,600.00	-
Minor Projects	-	-	-	-
Interdisciplinary Projects	-	-	-	-
Industry sponsored	-	-	-	-
Projects sponsored by the University/ College	-	-	-	-
Students research projects <i>(other than compulsory by the University)</i>	-	-	-	-
Any other(Specify)	-	-	-	-
Total	01		Rs.6,0,600.00	

3.7 No. of books published i) With ISBN No. Chapters in Edited Books

ii) Without ISBN No.

3.8 No. of University Departments receiving funds from

UGC-SAP CAS DST-FIST
DPE DBT Scheme/funds

3.9 For colleges
Autonomy CPE DBT Star Scheme
INSPIRE CE Any Other (specify)

3.10 Revenue generated through consultancy

3.11 No. of conferences

Organized by the Institution

Level	International	National	State	University	College
Number	Nil	Nil	01	-	-
Sponsoring agencies	-	-	-	-	-

3.12 No. of faculty served as experts, chairpersons or resource persons : 08

3.13 No. of collaborations:

3.14 No. of linkages created during this year: Nil

3.15 Total budget for research for current year in lakhs :

From funding agency

From Management of University/College

Total

Nil

3.16 No. of patents received this year

Type of Patent		Number
National	Applied	Nil
	Granted	Nil
International	Applied	Nil
	Granted	Nil
Commercialised	Applied	Nil
	Granted	Nil

3.17 No. of research awards/
recognitions received by faculty
research fellows

and

Of the institute in the year

Total	International	National	State	University	Dist	College
03	01	-	01	-	01	-

3.18 No. of faculty from the Institution

38

Who are Ph. D. Guides

And students registered under them

161

3.19 No. of Ph.D. awarded by faculty from the Institution

17

3.20 No. of Research scholars receiving the Fellowships (Newly enrolled + existing ones)

JRF 19

SRF 01

Project Fellows -

Any other 09

3.21 No. of students Participated in NSS events:

University level	200	State level	26
National level	01	International level	-

3.22 No. of students participated in NCC events:

University level	114	State level	08
National level	02	International level	-

3.23 No. of Awards won in NSS:

University level	-	State level	01
National level	01	International level	-

3.24 No. of Awards won in NCC:

University level	-	State level	-
National level	02	International level	-

3.25 No. of Extension activities organized

University forum	-	College forum	-
NCC	02	NSS	06
		Any other	04

3.26 Major Activities during the year in the sphere of extension activities and Institutional Social Responsibility

- . Red Cross has organized special Lectures related to health awareness.
- . NSS has organized Jatas, awareness Programs and street Plays

Criterion – IV

4. Infrastructure and Learning Resources

4.1 Details of increase in infrastructure facilities:

Facilities	Existing	Newly added	Source Fund	Total
Campus area	1,40,424.43 Sq mts.	NIL	-	1,40,424.43 Sq mts.
Class rooms	52	-	-	52
Laboratories	07	-	-	07
Seminar Halls	03	-	-	03
No. of important equipments purchased (\geq 1-0 lakh) during the current year.	00	-	-	-
Value of the equipment purchased during the year (Rs. in Lakhs)	00	-	-	-
Others	00	-	-	-

4.2 Computerization of administration and library

<ul style="list-style-type: none"> • A special Computer Lab DRUSHTI is exclusively dedicated to the Visually Impaired students • Students, Faculty and Research Scholars have access to 300 CDs, Videos, Journals and rare manuscripts • Photo copy facility is available to the students • 24x 7 Wi-Fi facilities is available in the library
--

4.3 Library services:

	Existing		Newly added		Total	
	No.	Value	No.	Value	No.	Value
Text Books	1,92,328	Rs.75000	364	Rs.74,795	1,92,692	Rs.195998
Reference Books	1,95,998		364			
e-Books	-	-	-	-	-	-
Journals	24 Monthly 288 Yearly	50,000	-	-	-	-
e-Journals	-	-	-	-	-	-
Digital Database	DIRC	-	-	-	-	-
CD & Video	290	-	04	-	294CDs	-
Others (specify)	-	-	-	-	-	-

4.4 Technology up gradation (overall)

	Total Computers	Computer Labs	Internet	Browsing Centres	Computer Centres	Office	Departments	Others
Existing	50	02	Yes	-	01	12	17	-
Added	18	-	-	-	-	05	05	-
Total	68	02	Yes	-	01	17	22	-

4.5 Computer, Internet access, training to teachers and students and any other programme for technology upgradation (Networking, e-Governance etc.)

Nil

4.6 Amount spent on maintenance in lakhs :

i) ICT	Nil
ii) Campus Infrastructure and facilities	2, 34,900
iii) Equipments	73,394
iv) Others	Nil

308294

Total:

Criterion – V

5. Student Support and Progression

5.1 Contribution of IQAC in enhancing awareness about Student Support Services

- At the beginning of the Odd Semester an orientation and Personality Development Programme is conducted for Freshers'
- All notifications and Circulars received from University of Mysore, Govt. of Karnataka and other organizations regarding scholarships and competitions are put up on the Notice Board

5.2 Efforts made by the institution for tracking the progression

- Transfer Certificate Ledger helps track students' progression to higher education
- Departments maintain records of all alumni who visit the department
- Teachers keep track via social media
-

5.3 (a) Total Number of students

UG	PG	Ph. D.	Others
2838	48	180	-

(b) No. of students outside the state

08

(c) No. of international students

01

No	%
01	-

Men

No	%

Women

Last Year (2015-2016)						This Year (2016-2017)					
General	SC	ST	OBC	Physically Challenged	Total	General	SC	ST	OBC	Physically Challenged	Total
89	1454	36	1111	03	3018	77	1301	365	1049	08	2838

Demand ratio 1:2.19 Dropout % NA

5.4 Details of student support mechanism for coaching for competitive examinations (If any)

Revis Nil

No. of students beneficiaries

5.5 No. of students qualified in these examinations

NET SET/SLET GATE CAT
IAS/IPS etc State PSC UPSC Others

5.6 Details of student counselling and career guidance

- IFBI conducted campus recruitment for ICICI Bank on 27/2/2017

No. of students benefitted

5.7 Details of campus placement

<i>On campus</i>			<i>Off Campus</i>
Number of Organizations Visited	Number of Students Participated	Number of Students Placed	Number of Students Placed
-	-	-	-

5.8 Details of gender sensitization programmes

On 8/3/2017, an awareness programme on *Safety of Women in Contemporary Society* and Institutional measures was organized.

5.9 Students Activities

5.9.1 No. of students participated in Sports, Games and other events

State/ University level National level International level

No. of students participated in cultural events

State/ University level National level International level

5.9.2 No. of medals /awards won by students in Sports, Games and other events

Sports : State/ University level National level International level

Cultural: State/ University level National level International level

5.10 Scholarships and Financial Support

	Number of students	Amount
Financial support from institution	-	-
Financial support from government	2504	1,23,84,130
Financial support from other sources	-	-
Number of students who received International/ National recognitions	-	-

5.11 Student organised / initiatives

Fairs : State/ University level National level International level

Exhibition: State/ University level National level International level

5.12 No. of social initiatives undertaken by the students

5.13 Major grievances of students (if any) redressed
No grievances are filed by students during the academic year

Criterion – VI

6. Governance, Leadership and Management

6.1 State the Vision and Mission of the institution

- Value based education for a value-based society”
- To provide opportunities for individuals from diverse backgrounds to pursue their educational goals.
- To offer educational programmes that are affordable and accessible to all.
- To focus on learning-learners to receive quality education and services that foster students’ success in achievement of their stated goal.
- To demonstrate a respect for differences and an appreciation of multiple perspective
- To strive to mould them into responsible and successful citizens.

6.2 Does the institution has a management information system

No

6.3 Quality improvement strategies adopted by the institution for each of the following:

6.3.1 Curriculum Development

- Twenty one teachers are on the Board of Studies of both UG and PG Courses of the University of Mysore. The members are largely involved in the revision of syllabus to cater to the needs of the students for their career growth. Whenever there is a change in the syllabus, teachers of such departments sit together at the beginning of the semester and plan out how the changes have to be incorporated and dealt with in the class.
- Each department finds different ways other than class room teaching alone to give a holistic approach to the subject.
- The Curriculum is thus carried out in such a manner to complete the syllabus well in time.

6.3.2 Teaching and Learning

- Highly qualified (53 with Ph.D.) and dedicated faculty
- Students are encouraged to make presentations on topics of their choice within a specific limited time period during their class hour
- Students are taken on field visits, Hospitals, Industries, De-Addiction Centres, Prisons, Police Academies, Govt. Offices, Rehabilitation Centres, Slums, Tribal visits, etc., to have first hand information in their

6.3.3 Examination and Evaluation

- Continuous evaluation is through different methods like internal assessment test, assignments, group discussion, seminars etc.
- Transparency is maintained in the evaluation process. Blue books are assessed and returned to the students. If there are any grievances students are encouraged to meet the individual teacher and the Head of the Department and the issue is resolved. If any discrepancy in IA marks is found by the student, once it is uploaded on the University Web site, such cases are addressed through the examination section of the College.

- Few teachers apply for Projects funded by UGC.
- Our College being a Research Centre has 38 recognized guides
- Course work for Research Scholars in Kannada and Folklore, Criminology and Geography is conducted in the campus.
- The College sanctions OOD facilities and encourages faculty to present papers at National and International Conferences

6.3.5 Library, ICT and physical infrastructure / instrumentation

- Library, housed in a separate heritage building
- A special Computer Lab DRUSHTI is exclusively dedicated to the Visually Impaired students
- Library has more than 1, 90,000 books which include Text Books as well as Reference books
- Students, Faculty and Research Scholars have access to 300 CDs, Videos, Journals and rare manuscripts
- Photo copying facility available
- 24x7 Wi-Fi facility is available in the library.
- 52 classrooms, 07 Labs and 03 Seminar Halls
- 05 classrooms with ICT facility

- A well chalked out Time Table makes sure that 92 % of our students have no waiting time between classes

- Lunch breaks are staggered for BA and Commerce Classes

- All such departments where the teaching faculty have registered for PhD and are expected to complete the course work which is held on

6.3.7 Faculty and Staff recruitment

- As per University Regulations

6.3.8 Industry Interaction / Collaboration

- Though no formal industry interaction takes place, at individual level, teachers who have contacts introduce students to Managements and Industrialists of their respective and related fields

6.3.9 Admission of Students

- Admission of students is through a very transparent process. The prospectus and the application form are priced very moderately
- SSP software is used for short listing the students based on the prescribed reservation policy of the Govt. Of Karnataka, cum merit
- Lists are announced and the admission process is taken care of by a committee that ensures all fairness in admission

6.4 Welfare schemes for

Teaching	Yes
Non teaching	Yes
Students	Yes

6.5 Total corpus fund generated

Nil

6.6 Whether annual financial audit has been done Yes

6.7 Whether Academic and Administrative Audit (AAA) has been done?

Audit Type	External		Internal	
	Yes/No	Agency	Yes/No	Authority
Academic	-	-	-	-
Administrative	-	-	-	-

6.8 Does the University/ Autonomous College declare results within 30 days?

For UG Programmes body Yes No

For PG Programmes Yes No

6.9 What efforts are made by the University/ Autonomous College for Examination Reforms?

NA

6.10 What efforts are made by the University to promote autonomy in the affiliated/constituent colleges?

NA

6.11 Activities and support from the Alumni Association

Nil

6.12 Activities and support from the Parent – Teacher Association

Nil

6.13 Development programmes for support staff

Nil

6.14 Initiatives taken by the institution to make the campus eco-friendly

- Using recycled water for watering the plants in the campus.
- Planting of ornamental plants
- Well maintained sprawling lawns

Criterion – VII

7. Innovations and Best Practices

7.1 Innovations introduced during this academic year which have created a positive impact on the Functioning of the institution. Give details.

- Centralized IA time table for 147 papers reduced to 4 days
- Attracting endowment to conduct seminars and competitions

7.2 Provide the Action Taken Report (ATR) based on the plan of action decided upon at the Beginning of the year

- Two exhibitions, one seminar and interactive sessions with distinguished experts were organized
- Competitions were organized for students

7.3 Give two Best Practices of the institution (*please see the format in the NAAC Self-study Manuals*)

- Environmental friendly policy of the College
- Empowering first generation literate

**Provide the details in annexure (annexure need to be numbered as i, ii,iii)*

7.4 Contribution to environmental awareness / protection

- Judicious use of paper
- NSS students promoted programmes during the camps in the villages
- Awareness rally organized on the occasion of World water day

7.5 Whether environmental audit was conducted? Yes

No

7.6 Any other relevant information the institution wishes to add. (for example SWOT Analysis)

SL	STRENGTHS	SL	WEAKNESS
----	-----------	----	----------

NO		NO	
1	Located in the centre of the city and easily accessible	1	No financial autonomy
2	Being a Constituent College, well supported by the University of Mysore	2	No appointment of permanent faculty since 2007
3	Adequate hostel facilities for students	3	Delayed appointment of guest faculty at the beginning of the odd semester
4	Moderate fee structure		
5	A good number of highly qualified teachers, with over 90% holding doctoral degrees.		
6	Good facilities for Sports, NSS & NCC		
7	A century old library, with large number of books on variety of subjects		
8	In house health centre, indoor gymnasium, tennis courts and information centre.		
9	Unusual and rare subjects with unique combinations are offered		
	OPPORTUNITIES		THREATS
1	Scope for expansion of PG courses	1	Achieving a better overall pass percentages
2	Large number of Research Guides & Research Scholars, Hence, there is scope for improvement in research activities	2	Shortage of class rooms
3	With good facilities for sports, NSS & NCC opportunities for students to excel.	3	Largely dependent on guest faculty and contractual staff

www.ugc.ac.in

Home About Us Organization Commission Universities Colleges Publications

PRINCIPAL
Maharaja's College
University of Mysore
Mysore-570 005

Universities & Colleges

- Colleges Under Section 2(f) & 12(B)
- Autonomous Colleges
- Colleges With Potential for Excellence
- Academic Staff Colleges
- Universities (UPE)
- Centres (CPEPA)
- Basic Scientific Research
- Visiting Committee Reports
- Central Universities
- State Universities List
- Deemed Universities
- Private Universities
- Fake Universities

Colleges under section 2(f) & 12(B) of the UGC Act 1956

Consolidated List of Colleges under section 2(f)/12(B)

The University Grants Commission (UGC) provides financial assistance to eligible colleges which are included under Section 2(f)* and declared fit to receive central assistance (UGC grant) under Section 12 (B)** of UGC Act, 1956 as per approved pattern of assistance under various schemes.

* The UGC had notified Regulations for recognition of colleges under Section 2(f) of the UGC Act, 1956. The colleges are brought under the purview of UGC in terms of these Regulations as and when the proposals are received from the colleges for inclusion under Section 2(f) and they are found fit for inclusion as per the provisions contained in the Regulations.

** Apart from inclusion of colleges under Section 2(f), the UGC includes the Colleges under Section 12(B) of its Act in terms of Rules framed under the Act. This makes the colleges eligible for central assistance from the Government of India or any organization receiving funds from the Central Government.

For Students

- About NET | UGC NET Online
- Ragging Related Circulars
- Fake Universities | Educational Loan

For Faculty

- Honours and Awards | UGC Regulations
- Pay Related Orders | M R P
- Faculty Recharge | Faculty Development

MORE

- Notices | Circulars | Tenders | Jobs | UGC ROs | Right to Information Act
- Other Higher Education Links
- Contact

Annexure I

www.ugc.ac.in/colleges/

PRINCIPAL

Mysore University, Mysore

Name and address of the college	Status	Year of Estb.	Nature of Affiliation	Teaching Upto	Govt or Non Govt	Aided or Unaided
J.S.S. College Gundalpet Dist. Chamaraja Nagar - 571 111 Karnataka	2(f) and 12(B)	1983	Permanent	Bachelor's	Non Government	
J.S.S. College for Women Kollegal Dist. Mysore - 571 440 Karnataka	2(f) and 12(B)	1983	Permanent	Bachelor's	Non Government	
J.S.S. College for Women (Autonomous) Saraswathipuram Mysore 570 009 Karnataka	2(f) and 12(B)	1954	Permanent	Bachelor's	Non Government	
J.S.S. College of Arts, Commerce & Science Saraswathipuram Dist. Mysore - 9 Karnataka	2(f) and 12(B)	1970	Permanent	Bachelor's	Non Government	
J.S.S. College of Arts, Commerce & Science Chamarajanagar Dist. Chamaraja Nagar - 571 313 Karnataka	2(f) and 12(B)	1967	Permanent	Bachelor's	Non Government	
J.S.S. College of Arts, Science and Commerce Ooty Road Dist. Mysore - 570 004 Karnataka	2(f) and 12(B)	1964	Permanent	Bachelor's	Non Government	
J.S.S. Law College Kuvempunagar Dist. Mysore - 570 023 Karnataka	2(f) and 12(B)	1982	Permanent	Bachelor's	Non Government	
JSS Institute of Speech and Hearing Ooty Road Mysore - 570 025 Karnataka	2(f)	2001	Temporary	Master's	Non Government	Unaided
M. Krishna Law College Hassan Dist. Hassan - 573 201 Karnataka	2(f) and 12(B)	1974	Permanent	Bachelor's	Non Government	
Maharaja's College Mysore Dist. Mysore - 570 005 Karnataka	2(f) and 12(B)	1837	Permanent	Bachelor's	Government	

As on 30.11.2015

CPP-I/C

Page 418 of 1265

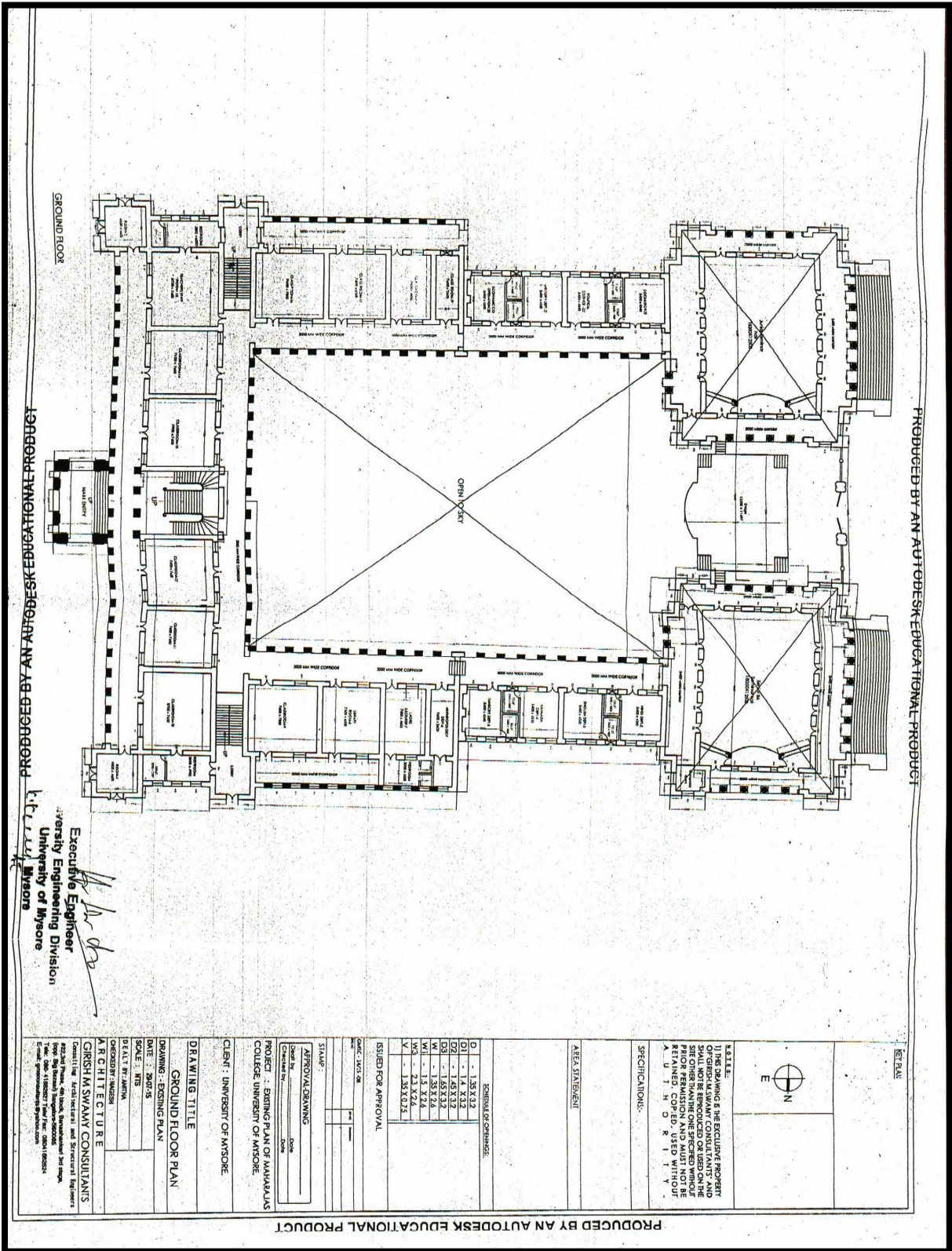

PRODUCED BY AN AUTODESK EDUCATIONAL PRODUCT

PRODUCED BY AN AUTODESK EDUCATIONAL PRODUCT

Executive Engineer
University of Mysore
Mysore

<p>REVISIONS</p>	
<p>DATE</p>	
<p>SCALE</p>	
<p>PROJECT : ENGINEERING PLAN OF MAHARAJAS COLLEGE UNIVERSITY OF MYSORE.</p>	
<p>CLIENT : UNIVERSITY OF MYSORE.</p>	
<p>DRAWING TITLE</p>	
<p>DRAWING : EXISTING PLAN</p>	
<p>DATE : 2007-15</p>	
<p>SCALE : 1/8</p>	
<p>DRAWN BY : JAYANTH</p>	
<p>CHECKED BY : JAYANTH</p>	
<p>ARCHITECTURE</p>	
<p>GIRESH M SWAMY CONSULTANTS</p>	
<p>Ground Floor, 4th Block, Banashankari 3rd Stage, Mysore.</p>	
<p>Phone : 0824-1180027 Fax : 0824-1180024 Email : gmswamy@rediffmail.com</p>	
<p>ISSUED FOR APPROVAL</p>	
<p>SCHEDULE OF CHANGES:</p>	
D1	1.35 X 3.2
D2	1.4 X 3.2
D3	1.65 X 3.2
M1	1.38 X 2.6
M2	1.5 X 2.6
V	1.35 X 2.2
<p>AREA STATEMENT</p>	
<p>SPECIFICATIONS:</p>	
<p>NOTE: 1) THIS DRAWING IS THE EXCLUSIVE PROPERTY OF GIRESH M SWAMY CONSULTANTS AND NO PART OF IT SHALL BE REPRODUCED OR TRANSMITTED IN ANY FORM OR BY ANY MEANS, ELECTRONIC OR MECHANICAL, INCLUDING PHOTOCOPYING, RECORDING, OR BY ANY INFORMATION STORAGE AND RETRIEVAL SYSTEM, WITHOUT THE PRIOR PERMISSION AND MUST NOT BE KEPT IN ANY FORM, USED WITHOUT PERMISSION.</p>	

PRODUCED BY AN AUTODESK EDUCATIONAL PRODUCT

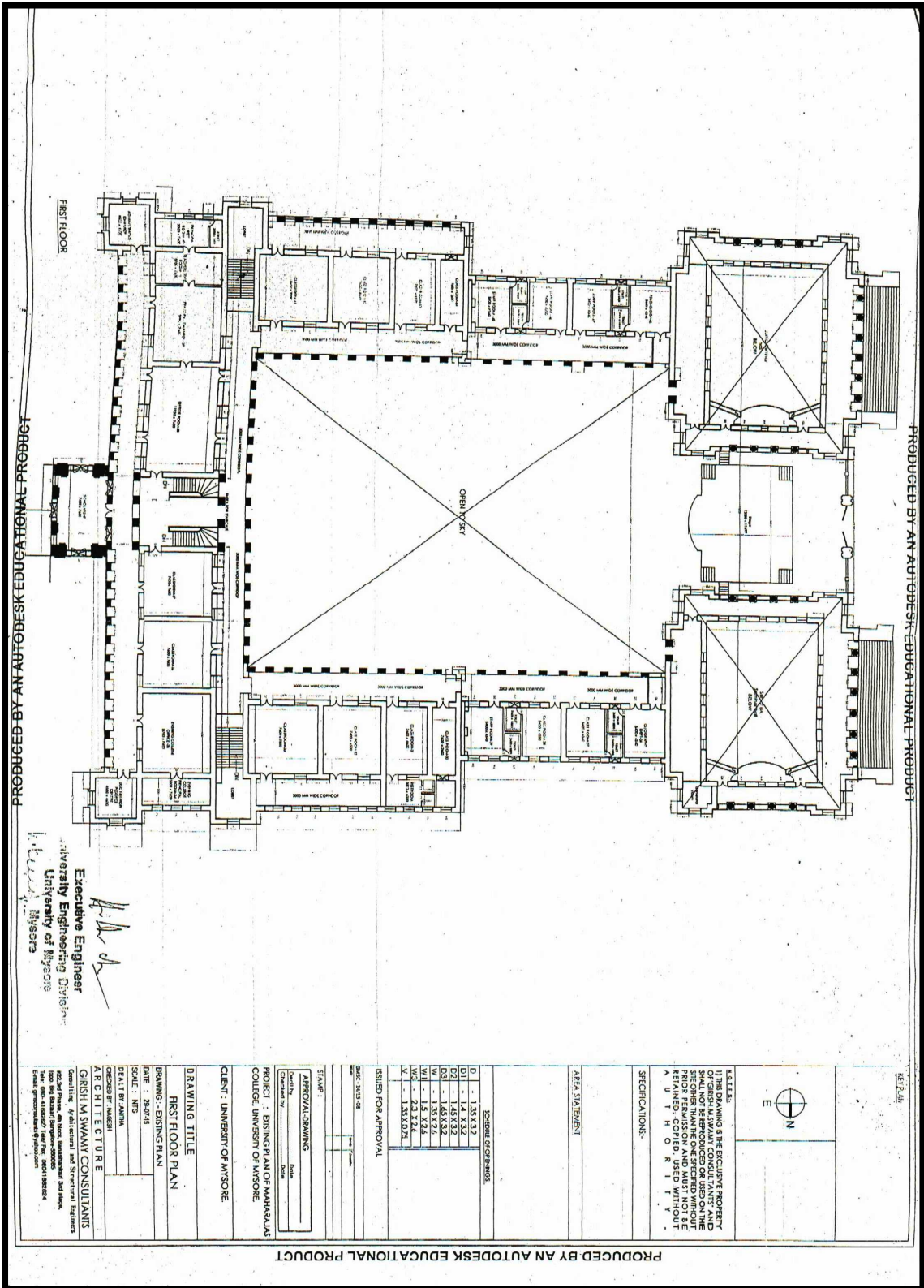

Executive Engineer
 University Engineering Division
 Mysore
 University of Mysore
 Mysore

<p>NOTE:</p> <p>1) THE DRAWING IS THE EXCLUSIVE PROPERTY OF THE ARCHITECT AND SHALL NOT BE REPRODUCED OR USED ON THE SITE OTHER THAN THE ONE SPECIFIED WITHOUT THE WRITTEN PERMISSION OF THE ARCHITECT.</p>																																																																																																																																																																																																																																																																																																																																																													
<p>SCALE:</p> <p>1:100</p>																																																																																																																																																																																																																																																																																																																																																													
<p>AREA STATEMENT</p>																																																																																																																																																																																																																																																																																																																																																													
<p>SCHEDULE OF COSTS:</p> <table border="1"> <tr><td>D</td><td>1.35 X 3.2</td></tr> <tr><td>D1</td><td>1.4 X 3.2</td></tr> <tr><td>D2</td><td>1.45 X 3.2</td></tr> <tr><td>D3</td><td>1.5 X 3.2</td></tr> <tr><td>D4</td><td>1.55 X 3.2</td></tr> <tr><td>D5</td><td>1.6 X 3.2</td></tr> <tr><td>D6</td><td>1.65 X 3.2</td></tr> <tr><td>D7</td><td>1.7 X 3.2</td></tr> <tr><td>D8</td><td>1.75 X 3.2</td></tr> <tr><td>D9</td><td>1.8 X 3.2</td></tr> <tr><td>D10</td><td>1.85 X 3.2</td></tr> <tr><td>D11</td><td>1.9 X 3.2</td></tr> <tr><td>D12</td><td>1.95 X 3.2</td></tr> <tr><td>D13</td><td>2.0 X 3.2</td></tr> <tr><td>D14</td><td>2.05 X 3.2</td></tr> <tr><td>D15</td><td>2.1 X 3.2</td></tr> <tr><td>D16</td><td>2.15 X 3.2</td></tr> <tr><td>D17</td><td>2.2 X 3.2</td></tr> <tr><td>D18</td><td>2.25 X 3.2</td></tr> <tr><td>D19</td><td>2.3 X 3.2</td></tr> <tr><td>D20</td><td>2.35 X 3.2</td></tr> <tr><td>D21</td><td>2.4 X 3.2</td></tr> <tr><td>D22</td><td>2.45 X 3.2</td></tr> <tr><td>D23</td><td>2.5 X 3.2</td></tr> <tr><td>D24</td><td>2.55 X 3.2</td></tr> <tr><td>D25</td><td>2.6 X 3.2</td></tr> <tr><td>D26</td><td>2.65 X 3.2</td></tr> <tr><td>D27</td><td>2.7 X 3.2</td></tr> <tr><td>D28</td><td>2.75 X 3.2</td></tr> <tr><td>D29</td><td>2.8 X 3.2</td></tr> <tr><td>D30</td><td>2.85 X 3.2</td></tr> <tr><td>D31</td><td>2.9 X 3.2</td></tr> <tr><td>D32</td><td>2.95 X 3.2</td></tr> <tr><td>D33</td><td>3.0 X 3.2</td></tr> <tr><td>D34</td><td>3.05 X 3.2</td></tr> <tr><td>D35</td><td>3.1 X 3.2</td></tr> <tr><td>D36</td><td>3.15 X 3.2</td></tr> <tr><td>D37</td><td>3.2 X 3.2</td></tr> <tr><td>D38</td><td>3.25 X 3.2</td></tr> <tr><td>D39</td><td>3.3 X 3.2</td></tr> <tr><td>D40</td><td>3.35 X 3.2</td></tr> <tr><td>D41</td><td>3.4 X 3.2</td></tr> <tr><td>D42</td><td>3.45 X 3.2</td></tr> <tr><td>D43</td><td>3.5 X 3.2</td></tr> <tr><td>D44</td><td>3.55 X 3.2</td></tr> <tr><td>D45</td><td>3.6 X 3.2</td></tr> <tr><td>D46</td><td>3.65 X 3.2</td></tr> <tr><td>D47</td><td>3.7 X 3.2</td></tr> <tr><td>D48</td><td>3.75 X 3.2</td></tr> <tr><td>D49</td><td>3.8 X 3.2</td></tr> <tr><td>D50</td><td>3.85 X 3.2</td></tr> <tr><td>D51</td><td>3.9 X 3.2</td></tr> <tr><td>D52</td><td>3.95 X 3.2</td></tr> <tr><td>D53</td><td>4.0 X 3.2</td></tr> <tr><td>D54</td><td>4.05 X 3.2</td></tr> <tr><td>D55</td><td>4.1 X 3.2</td></tr> <tr><td>D56</td><td>4.15 X 3.2</td></tr> <tr><td>D57</td><td>4.2 X 3.2</td></tr> <tr><td>D58</td><td>4.25 X 3.2</td></tr> <tr><td>D59</td><td>4.3 X 3.2</td></tr> <tr><td>D60</td><td>4.35 X 3.2</td></tr> <tr><td>D61</td><td>4.4 X 3.2</td></tr> <tr><td>D62</td><td>4.45 X 3.2</td></tr> <tr><td>D63</td><td>4.5 X 3.2</td></tr> <tr><td>D64</td><td>4.55 X 3.2</td></tr> <tr><td>D65</td><td>4.6 X 3.2</td></tr> <tr><td>D66</td><td>4.65 X 3.2</td></tr> <tr><td>D67</td><td>4.7 X 3.2</td></tr> <tr><td>D68</td><td>4.75 X 3.2</td></tr> <tr><td>D69</td><td>4.8 X 3.2</td></tr> <tr><td>D70</td><td>4.85 X 3.2</td></tr> <tr><td>D71</td><td>4.9 X 3.2</td></tr> <tr><td>D72</td><td>4.95 X 3.2</td></tr> <tr><td>D73</td><td>5.0 X 3.2</td></tr> <tr><td>D74</td><td>5.05 X 3.2</td></tr> <tr><td>D75</td><td>5.1 X 3.2</td></tr> <tr><td>D76</td><td>5.15 X 3.2</td></tr> <tr><td>D77</td><td>5.2 X 3.2</td></tr> <tr><td>D78</td><td>5.25 X 3.2</td></tr> <tr><td>D79</td><td>5.3 X 3.2</td></tr> <tr><td>D80</td><td>5.35 X 3.2</td></tr> <tr><td>D81</td><td>5.4 X 3.2</td></tr> <tr><td>D82</td><td>5.45 X 3.2</td></tr> <tr><td>D83</td><td>5.5 X 3.2</td></tr> <tr><td>D84</td><td>5.55 X 3.2</td></tr> <tr><td>D85</td><td>5.6 X 3.2</td></tr> <tr><td>D86</td><td>5.65 X 3.2</td></tr> <tr><td>D87</td><td>5.7 X 3.2</td></tr> <tr><td>D88</td><td>5.75 X 3.2</td></tr> <tr><td>D89</td><td>5.8 X 3.2</td></tr> <tr><td>D90</td><td>5.85 X 3.2</td></tr> <tr><td>D91</td><td>5.9 X 3.2</td></tr> <tr><td>D92</td><td>5.95 X 3.2</td></tr> <tr><td>D93</td><td>6.0 X 3.2</td></tr> <tr><td>D94</td><td>6.05 X 3.2</td></tr> <tr><td>D95</td><td>6.1 X 3.2</td></tr> <tr><td>D96</td><td>6.15 X 3.2</td></tr> <tr><td>D97</td><td>6.2 X 3.2</td></tr> <tr><td>D98</td><td>6.25 X 3.2</td></tr> <tr><td>D99</td><td>6.3 X 3.2</td></tr> <tr><td>D100</td><td>6.35 X 3.2</td></tr> <tr><td>D101</td><td>6.4 X 3.2</td></tr> <tr><td>D102</td><td>6.45 X 3.2</td></tr> <tr><td>D103</td><td>6.5 X 3.2</td></tr> <tr><td>D104</td><td>6.55 X 3.2</td></tr> <tr><td>D105</td><td>6.6 X 3.2</td></tr> <tr><td>D106</td><td>6.65 X 3.2</td></tr> <tr><td>D107</td><td>6.7 X 3.2</td></tr> <tr><td>D108</td><td>6.75 X 3.2</td></tr> <tr><td>D109</td><td>6.8 X 3.2</td></tr> <tr><td>D110</td><td>6.85 X 3.2</td></tr> <tr><td>D111</td><td>6.9 X 3.2</td></tr> <tr><td>D112</td><td>6.95 X 3.2</td></tr> <tr><td>D113</td><td>7.0 X 3.2</td></tr> <tr><td>D114</td><td>7.05 X 3.2</td></tr> <tr><td>D115</td><td>7.1 X 3.2</td></tr> <tr><td>D116</td><td>7.15 X 3.2</td></tr> <tr><td>D117</td><td>7.2 X 3.2</td></tr> <tr><td>D118</td><td>7.25 X 3.2</td></tr> <tr><td>D119</td><td>7.3 X 3.2</td></tr> <tr><td>D120</td><td>7.35 X 3.2</td></tr> <tr><td>D121</td><td>7.4 X 3.2</td></tr> <tr><td>D122</td><td>7.45 X 3.2</td></tr> <tr><td>D123</td><td>7.5 X 3.2</td></tr> <tr><td>D124</td><td>7.55 X 3.2</td></tr> <tr><td>D125</td><td>7.6 X 3.2</td></tr> <tr><td>D126</td><td>7.65 X 3.2</td></tr> <tr><td>D127</td><td>7.7 X 3.2</td></tr> <tr><td>D128</td><td>7.75 X 3.2</td></tr> <tr><td>D129</td><td>7.8 X 3.2</td></tr> <tr><td>D130</td><td>7.85 X 3.2</td></tr> <tr><td>D131</td><td>7.9 X 3.2</td></tr> <tr><td>D132</td><td>7.95 X 3.2</td></tr> <tr><td>D133</td><td>8.0 X 3.2</td></tr> <tr><td>D134</td><td>8.05 X 3.2</td></tr> <tr><td>D135</td><td>8.1 X 3.2</td></tr> <tr><td>D136</td><td>8.15 X 3.2</td></tr> <tr><td>D137</td><td>8.2 X 3.2</td></tr> <tr><td>D138</td><td>8.25 X 3.2</td></tr> <tr><td>D139</td><td>8.3 X 3.2</td></tr> <tr><td>D140</td><td>8.35 X 3.2</td></tr> <tr><td>D141</td><td>8.4 X 3.2</td></tr> <tr><td>D142</td><td>8.45 X 3.2</td></tr> <tr><td>D143</td><td>8.5 X 3.2</td></tr> <tr><td>D144</td><td>8.55 X 3.2</td></tr> <tr><td>D145</td><td>8.6 X 3.2</td></tr> <tr><td>D146</td><td>8.65 X 3.2</td></tr> <tr><td>D147</td><td>8.7 X 3.2</td></tr> <tr><td>D148</td><td>8.75 X 3.2</td></tr> <tr><td>D149</td><td>8.8 X 3.2</td></tr> <tr><td>D150</td><td>8.85 X 3.2</td></tr> <tr><td>D151</td><td>8.9 X 3.2</td></tr> <tr><td>D152</td><td>8.95 X 3.2</td></tr> <tr><td>D153</td><td>9.0 X 3.2</td></tr> <tr><td>D154</td><td>9.05 X 3.2</td></tr> <tr><td>D155</td><td>9.1 X 3.2</td></tr> <tr><td>D156</td><td>9.15 X 3.2</td></tr> <tr><td>D157</td><td>9.2 X 3.2</td></tr> <tr><td>D158</td><td>9.25 X 3.2</td></tr> <tr><td>D159</td><td>9.3 X 3.2</td></tr> <tr><td>D160</td><td>9.35 X 3.2</td></tr> <tr><td>D161</td><td>9.4 X 3.2</td></tr> <tr><td>D162</td><td>9.45 X 3.2</td></tr> <tr><td>D163</td><td>9.5 X 3.2</td></tr> <tr><td>D164</td><td>9.55 X 3.2</td></tr> <tr><td>D165</td><td>9.6 X 3.2</td></tr> <tr><td>D166</td><td>9.65 X 3.2</td></tr> <tr><td>D167</td><td>9.7 X 3.2</td></tr> <tr><td>D168</td><td>9.75 X 3.2</td></tr> <tr><td>D169</td><td>9.8 X 3.2</td></tr> <tr><td>D170</td><td>9.85 X 3.2</td></tr> <tr><td>D171</td><td>9.9 X 3.2</td></tr> <tr><td>D172</td><td>9.95 X 3.2</td></tr> <tr><td>D173</td><td>10.0 X 3.2</td></tr> </table>		D	1.35 X 3.2	D1	1.4 X 3.2	D2	1.45 X 3.2	D3	1.5 X 3.2	D4	1.55 X 3.2	D5	1.6 X 3.2	D6	1.65 X 3.2	D7	1.7 X 3.2	D8	1.75 X 3.2	D9	1.8 X 3.2	D10	1.85 X 3.2	D11	1.9 X 3.2	D12	1.95 X 3.2	D13	2.0 X 3.2	D14	2.05 X 3.2	D15	2.1 X 3.2	D16	2.15 X 3.2	D17	2.2 X 3.2	D18	2.25 X 3.2	D19	2.3 X 3.2	D20	2.35 X 3.2	D21	2.4 X 3.2	D22	2.45 X 3.2	D23	2.5 X 3.2	D24	2.55 X 3.2	D25	2.6 X 3.2	D26	2.65 X 3.2	D27	2.7 X 3.2	D28	2.75 X 3.2	D29	2.8 X 3.2	D30	2.85 X 3.2	D31	2.9 X 3.2	D32	2.95 X 3.2	D33	3.0 X 3.2	D34	3.05 X 3.2	D35	3.1 X 3.2	D36	3.15 X 3.2	D37	3.2 X 3.2	D38	3.25 X 3.2	D39	3.3 X 3.2	D40	3.35 X 3.2	D41	3.4 X 3.2	D42	3.45 X 3.2	D43	3.5 X 3.2	D44	3.55 X 3.2	D45	3.6 X 3.2	D46	3.65 X 3.2	D47	3.7 X 3.2	D48	3.75 X 3.2	D49	3.8 X 3.2	D50	3.85 X 3.2	D51	3.9 X 3.2	D52	3.95 X 3.2	D53	4.0 X 3.2	D54	4.05 X 3.2	D55	4.1 X 3.2	D56	4.15 X 3.2	D57	4.2 X 3.2	D58	4.25 X 3.2	D59	4.3 X 3.2	D60	4.35 X 3.2	D61	4.4 X 3.2	D62	4.45 X 3.2	D63	4.5 X 3.2	D64	4.55 X 3.2	D65	4.6 X 3.2	D66	4.65 X 3.2	D67	4.7 X 3.2	D68	4.75 X 3.2	D69	4.8 X 3.2	D70	4.85 X 3.2	D71	4.9 X 3.2	D72	4.95 X 3.2	D73	5.0 X 3.2	D74	5.05 X 3.2	D75	5.1 X 3.2	D76	5.15 X 3.2	D77	5.2 X 3.2	D78	5.25 X 3.2	D79	5.3 X 3.2	D80	5.35 X 3.2	D81	5.4 X 3.2	D82	5.45 X 3.2	D83	5.5 X 3.2	D84	5.55 X 3.2	D85	5.6 X 3.2	D86	5.65 X 3.2	D87	5.7 X 3.2	D88	5.75 X 3.2	D89	5.8 X 3.2	D90	5.85 X 3.2	D91	5.9 X 3.2	D92	5.95 X 3.2	D93	6.0 X 3.2	D94	6.05 X 3.2	D95	6.1 X 3.2	D96	6.15 X 3.2	D97	6.2 X 3.2	D98	6.25 X 3.2	D99	6.3 X 3.2	D100	6.35 X 3.2	D101	6.4 X 3.2	D102	6.45 X 3.2	D103	6.5 X 3.2	D104	6.55 X 3.2	D105	6.6 X 3.2	D106	6.65 X 3.2	D107	6.7 X 3.2	D108	6.75 X 3.2	D109	6.8 X 3.2	D110	6.85 X 3.2	D111	6.9 X 3.2	D112	6.95 X 3.2	D113	7.0 X 3.2	D114	7.05 X 3.2	D115	7.1 X 3.2	D116	7.15 X 3.2	D117	7.2 X 3.2	D118	7.25 X 3.2	D119	7.3 X 3.2	D120	7.35 X 3.2	D121	7.4 X 3.2	D122	7.45 X 3.2	D123	7.5 X 3.2	D124	7.55 X 3.2	D125	7.6 X 3.2	D126	7.65 X 3.2	D127	7.7 X 3.2	D128	7.75 X 3.2	D129	7.8 X 3.2	D130	7.85 X 3.2	D131	7.9 X 3.2	D132	7.95 X 3.2	D133	8.0 X 3.2	D134	8.05 X 3.2	D135	8.1 X 3.2	D136	8.15 X 3.2	D137	8.2 X 3.2	D138	8.25 X 3.2	D139	8.3 X 3.2	D140	8.35 X 3.2	D141	8.4 X 3.2	D142	8.45 X 3.2	D143	8.5 X 3.2	D144	8.55 X 3.2	D145	8.6 X 3.2	D146	8.65 X 3.2	D147	8.7 X 3.2	D148	8.75 X 3.2	D149	8.8 X 3.2	D150	8.85 X 3.2	D151	8.9 X 3.2	D152	8.95 X 3.2	D153	9.0 X 3.2	D154	9.05 X 3.2	D155	9.1 X 3.2	D156	9.15 X 3.2	D157	9.2 X 3.2	D158	9.25 X 3.2	D159	9.3 X 3.2	D160	9.35 X 3.2	D161	9.4 X 3.2	D162	9.45 X 3.2	D163	9.5 X 3.2	D164	9.55 X 3.2	D165	9.6 X 3.2	D166	9.65 X 3.2	D167	9.7 X 3.2	D168	9.75 X 3.2	D169	9.8 X 3.2	D170	9.85 X 3.2	D171	9.9 X 3.2	D172	9.95 X 3.2	D173	10.0 X 3.2
D	1.35 X 3.2																																																																																																																																																																																																																																																																																																																																																												
D1	1.4 X 3.2																																																																																																																																																																																																																																																																																																																																																												
D2	1.45 X 3.2																																																																																																																																																																																																																																																																																																																																																												
D3	1.5 X 3.2																																																																																																																																																																																																																																																																																																																																																												
D4	1.55 X 3.2																																																																																																																																																																																																																																																																																																																																																												
D5	1.6 X 3.2																																																																																																																																																																																																																																																																																																																																																												
D6	1.65 X 3.2																																																																																																																																																																																																																																																																																																																																																												
D7	1.7 X 3.2																																																																																																																																																																																																																																																																																																																																																												
D8	1.75 X 3.2																																																																																																																																																																																																																																																																																																																																																												
D9	1.8 X 3.2																																																																																																																																																																																																																																																																																																																																																												
D10	1.85 X 3.2																																																																																																																																																																																																																																																																																																																																																												
D11	1.9 X 3.2																																																																																																																																																																																																																																																																																																																																																												
D12	1.95 X 3.2																																																																																																																																																																																																																																																																																																																																																												
D13	2.0 X 3.2																																																																																																																																																																																																																																																																																																																																																												
D14	2.05 X 3.2																																																																																																																																																																																																																																																																																																																																																												
D15	2.1 X 3.2																																																																																																																																																																																																																																																																																																																																																												
D16	2.15 X 3.2																																																																																																																																																																																																																																																																																																																																																												
D17	2.2 X 3.2																																																																																																																																																																																																																																																																																																																																																												
D18	2.25 X 3.2																																																																																																																																																																																																																																																																																																																																																												
D19	2.3 X 3.2																																																																																																																																																																																																																																																																																																																																																												
D20	2.35 X 3.2																																																																																																																																																																																																																																																																																																																																																												
D21	2.4 X 3.2																																																																																																																																																																																																																																																																																																																																																												
D22	2.45 X 3.2																																																																																																																																																																																																																																																																																																																																																												
D23	2.5 X 3.2																																																																																																																																																																																																																																																																																																																																																												
D24	2.55 X 3.2																																																																																																																																																																																																																																																																																																																																																												
D25	2.6 X 3.2																																																																																																																																																																																																																																																																																																																																																												
D26	2.65 X 3.2																																																																																																																																																																																																																																																																																																																																																												
D27	2.7 X 3.2																																																																																																																																																																																																																																																																																																																																																												
D28	2.75 X 3.2																																																																																																																																																																																																																																																																																																																																																												
D29	2.8 X 3.2																																																																																																																																																																																																																																																																																																																																																												
D30	2.85 X 3.2																																																																																																																																																																																																																																																																																																																																																												
D31	2.9 X 3.2																																																																																																																																																																																																																																																																																																																																																												
D32	2.95 X 3.2																																																																																																																																																																																																																																																																																																																																																												
D33	3.0 X 3.2																																																																																																																																																																																																																																																																																																																																																												
D34	3.05 X 3.2																																																																																																																																																																																																																																																																																																																																																												
D35	3.1 X 3.2																																																																																																																																																																																																																																																																																																																																																												
D36	3.15 X 3.2																																																																																																																																																																																																																																																																																																																																																												
D37	3.2 X 3.2																																																																																																																																																																																																																																																																																																																																																												
D38	3.25 X 3.2																																																																																																																																																																																																																																																																																																																																																												
D39	3.3 X 3.2																																																																																																																																																																																																																																																																																																																																																												
D40	3.35 X 3.2																																																																																																																																																																																																																																																																																																																																																												
D41	3.4 X 3.2																																																																																																																																																																																																																																																																																																																																																												
D42	3.45 X 3.2																																																																																																																																																																																																																																																																																																																																																												
D43	3.5 X 3.2																																																																																																																																																																																																																																																																																																																																																												
D44	3.55 X 3.2																																																																																																																																																																																																																																																																																																																																																												
D45	3.6 X 3.2																																																																																																																																																																																																																																																																																																																																																												
D46	3.65 X 3.2																																																																																																																																																																																																																																																																																																																																																												
D47	3.7 X 3.2																																																																																																																																																																																																																																																																																																																																																												
D48	3.75 X 3.2																																																																																																																																																																																																																																																																																																																																																												
D49	3.8 X 3.2																																																																																																																																																																																																																																																																																																																																																												
D50	3.85 X 3.2																																																																																																																																																																																																																																																																																																																																																												
D51	3.9 X 3.2																																																																																																																																																																																																																																																																																																																																																												
D52	3.95 X 3.2																																																																																																																																																																																																																																																																																																																																																												
D53	4.0 X 3.2																																																																																																																																																																																																																																																																																																																																																												
D54	4.05 X 3.2																																																																																																																																																																																																																																																																																																																																																												
D55	4.1 X 3.2																																																																																																																																																																																																																																																																																																																																																												
D56	4.15 X 3.2																																																																																																																																																																																																																																																																																																																																																												
D57	4.2 X 3.2																																																																																																																																																																																																																																																																																																																																																												
D58	4.25 X 3.2																																																																																																																																																																																																																																																																																																																																																												
D59	4.3 X 3.2																																																																																																																																																																																																																																																																																																																																																												
D60	4.35 X 3.2																																																																																																																																																																																																																																																																																																																																																												
D61	4.4 X 3.2																																																																																																																																																																																																																																																																																																																																																												
D62	4.45 X 3.2																																																																																																																																																																																																																																																																																																																																																												
D63	4.5 X 3.2																																																																																																																																																																																																																																																																																																																																																												
D64	4.55 X 3.2																																																																																																																																																																																																																																																																																																																																																												
D65	4.6 X 3.2																																																																																																																																																																																																																																																																																																																																																												
D66	4.65 X 3.2																																																																																																																																																																																																																																																																																																																																																												
D67	4.7 X 3.2																																																																																																																																																																																																																																																																																																																																																												
D68	4.75 X 3.2																																																																																																																																																																																																																																																																																																																																																												
D69	4.8 X 3.2																																																																																																																																																																																																																																																																																																																																																												
D70	4.85 X 3.2																																																																																																																																																																																																																																																																																																																																																												
D71	4.9 X 3.2																																																																																																																																																																																																																																																																																																																																																												
D72	4.95 X 3.2																																																																																																																																																																																																																																																																																																																																																												
D73	5.0 X 3.2																																																																																																																																																																																																																																																																																																																																																												
D74	5.05 X 3.2																																																																																																																																																																																																																																																																																																																																																												
D75	5.1 X 3.2																																																																																																																																																																																																																																																																																																																																																												
D76	5.15 X 3.2																																																																																																																																																																																																																																																																																																																																																												
D77	5.2 X 3.2																																																																																																																																																																																																																																																																																																																																																												
D78	5.25 X 3.2																																																																																																																																																																																																																																																																																																																																																												
D79	5.3 X 3.2																																																																																																																																																																																																																																																																																																																																																												
D80	5.35 X 3.2																																																																																																																																																																																																																																																																																																																																																												
D81	5.4 X 3.2																																																																																																																																																																																																																																																																																																																																																												
D82	5.45 X 3.2																																																																																																																																																																																																																																																																																																																																																												
D83	5.5 X 3.2																																																																																																																																																																																																																																																																																																																																																												
D84	5.55 X 3.2																																																																																																																																																																																																																																																																																																																																																												
D85	5.6 X 3.2																																																																																																																																																																																																																																																																																																																																																												
D86	5.65 X 3.2																																																																																																																																																																																																																																																																																																																																																												
D87	5.7 X 3.2																																																																																																																																																																																																																																																																																																																																																												
D88	5.75 X 3.2																																																																																																																																																																																																																																																																																																																																																												
D89	5.8 X 3.2																																																																																																																																																																																																																																																																																																																																																												
D90	5.85 X 3.2																																																																																																																																																																																																																																																																																																																																																												
D91	5.9 X 3.2																																																																																																																																																																																																																																																																																																																																																												
D92	5.95 X 3.2																																																																																																																																																																																																																																																																																																																																																												
D93	6.0 X 3.2																																																																																																																																																																																																																																																																																																																																																												
D94	6.05 X 3.2																																																																																																																																																																																																																																																																																																																																																												
D95	6.1 X 3.2																																																																																																																																																																																																																																																																																																																																																												
D96	6.15 X 3.2																																																																																																																																																																																																																																																																																																																																																												
D97	6.2 X 3.2																																																																																																																																																																																																																																																																																																																																																												
D98	6.25 X 3.2																																																																																																																																																																																																																																																																																																																																																												
D99	6.3 X 3.2																																																																																																																																																																																																																																																																																																																																																												
D100	6.35 X 3.2																																																																																																																																																																																																																																																																																																																																																												
D101	6.4 X 3.2																																																																																																																																																																																																																																																																																																																																																												
D102	6.45 X 3.2																																																																																																																																																																																																																																																																																																																																																												
D103	6.5 X 3.2																																																																																																																																																																																																																																																																																																																																																												
D104	6.55 X 3.2																																																																																																																																																																																																																																																																																																																																																												
D105	6.6 X 3.2																																																																																																																																																																																																																																																																																																																																																												
D106	6.65 X 3.2																																																																																																																																																																																																																																																																																																																																																												
D107	6.7 X 3.2																																																																																																																																																																																																																																																																																																																																																												
D108	6.75 X 3.2																																																																																																																																																																																																																																																																																																																																																												
D109	6.8 X 3.2																																																																																																																																																																																																																																																																																																																																																												
D110	6.85 X 3.2																																																																																																																																																																																																																																																																																																																																																												
D111	6.9 X 3.2																																																																																																																																																																																																																																																																																																																																																												
D112	6.95 X 3.2																																																																																																																																																																																																																																																																																																																																																												
D113	7.0 X 3.2																																																																																																																																																																																																																																																																																																																																																												
D114	7.05 X 3.2																																																																																																																																																																																																																																																																																																																																																												
D115	7.1 X 3.2																																																																																																																																																																																																																																																																																																																																																												
D116	7.15 X 3.2																																																																																																																																																																																																																																																																																																																																																												
D117	7.2 X 3.2																																																																																																																																																																																																																																																																																																																																																												
D118	7.25 X 3.2																																																																																																																																																																																																																																																																																																																																																												
D119	7.3 X 3.2																																																																																																																																																																																																																																																																																																																																																												
D120	7.35 X 3.2																																																																																																																																																																																																																																																																																																																																																												
D121	7.4 X 3.2																																																																																																																																																																																																																																																																																																																																																												
D122	7.45 X 3.2																																																																																																																																																																																																																																																																																																																																																												
D123	7.5 X 3.2																																																																																																																																																																																																																																																																																																																																																												
D124	7.55 X 3.2																																																																																																																																																																																																																																																																																																																																																												
D125	7.6 X 3.2																																																																																																																																																																																																																																																																																																																																																												
D126	7.65 X 3.2																																																																																																																																																																																																																																																																																																																																																												
D127	7.7 X 3.2																																																																																																																																																																																																																																																																																																																																																												
D128	7.75 X 3.2																																																																																																																																																																																																																																																																																																																																																												
D129	7.8 X 3.2																																																																																																																																																																																																																																																																																																																																																												
D130	7.85 X 3.2																																																																																																																																																																																																																																																																																																																																																												
D131	7.9 X 3.2																																																																																																																																																																																																																																																																																																																																																												
D132	7.95 X 3.2																																																																																																																																																																																																																																																																																																																																																												
D133	8.0 X 3.2																																																																																																																																																																																																																																																																																																																																																												
D134	8.05 X 3.2																																																																																																																																																																																																																																																																																																																																																												
D135	8.1 X 3.2																																																																																																																																																																																																																																																																																																																																																												
D136	8.15 X 3.2																																																																																																																																																																																																																																																																																																																																																												
D137	8.2 X 3.2																																																																																																																																																																																																																																																																																																																																																												
D138	8.25 X 3.2																																																																																																																																																																																																																																																																																																																																																												
D139	8.3 X 3.2																																																																																																																																																																																																																																																																																																																																																												
D140	8.35 X 3.2																																																																																																																																																																																																																																																																																																																																																												
D141	8.4 X 3.2																																																																																																																																																																																																																																																																																																																																																												
D142	8.45 X 3.2																																																																																																																																																																																																																																																																																																																																																												
D143	8.5 X 3.2																																																																																																																																																																																																																																																																																																																																																												
D144	8.55 X 3.2																																																																																																																																																																																																																																																																																																																																																												
D145	8.6 X 3.2																																																																																																																																																																																																																																																																																																																																																												
D146	8.65 X 3.2																																																																																																																																																																																																																																																																																																																																																												
D147	8.7 X 3.2																																																																																																																																																																																																																																																																																																																																																												
D148	8.75 X 3.2																																																																																																																																																																																																																																																																																																																																																												
D149	8.8 X 3.2																																																																																																																																																																																																																																																																																																																																																												
D150	8.85 X 3.2																																																																																																																																																																																																																																																																																																																																																												
D151	8.9 X 3.2																																																																																																																																																																																																																																																																																																																																																												
D152	8.95 X 3.2																																																																																																																																																																																																																																																																																																																																																												
D153	9.0 X 3.2																																																																																																																																																																																																																																																																																																																																																												
D154	9.05 X 3.2																																																																																																																																																																																																																																																																																																																																																												
D155	9.1 X 3.2																																																																																																																																																																																																																																																																																																																																																												
D156	9.15 X 3.2																																																																																																																																																																																																																																																																																																																																																												
D157	9.2 X 3.2																																																																																																																																																																																																																																																																																																																																																												
D158	9.25 X 3.2																																																																																																																																																																																																																																																																																																																																																												
D159	9.3 X 3.2																																																																																																																																																																																																																																																																																																																																																												
D160	9.35 X 3.2																																																																																																																																																																																																																																																																																																																																																												
D161	9.4 X 3.2																																																																																																																																																																																																																																																																																																																																																												
D162	9.45 X 3.2																																																																																																																																																																																																																																																																																																																																																												
D163	9.5 X 3.2																																																																																																																																																																																																																																																																																																																																																												
D164	9.55 X 3.2																																																																																																																																																																																																																																																																																																																																																												
D165	9.6 X 3.2																																																																																																																																																																																																																																																																																																																																																												
D166	9.65 X 3.2																																																																																																																																																																																																																																																																																																																																																												
D167	9.7 X 3.2																																																																																																																																																																																																																																																																																																																																																												
D168	9.75 X 3.2																																																																																																																																																																																																																																																																																																																																																												
D169	9.8 X 3.2																																																																																																																																																																																																																																																																																																																																																												
D170	9.85 X 3.2																																																																																																																																																																																																																																																																																																																																																												
D171	9.9 X 3.2																																																																																																																																																																																																																																																																																																																																																												
D172	9.95 X 3.2																																																																																																																																																																																																																																																																																																																																																												
D173	10.0 X 3.2																																																																																																																																																																																																																																																																																																																																																												
<p>ISSUED FOR APPROVAL</p>																																																																																																																																																																																																																																																																																																																																																													
<p>DATE: 15/11/2018</p>																																																																																																																																																																																																																																																																																																																																																													
<p>STAMP:</p>																																																																																																																																																																																																																																																																																																																																																													
<p>APPROVAL/DRAWING</p>																																																																																																																																																																																																																																																																																																																																																													
<p>Checked by: _____</p>																																																																																																																																																																																																																																																																																																																																																													
<p>Checked by: _____</p>																																																																																																																																																																																																																																																																																																																																																													
<p>PROJECT : EXISTING PLAN OF MAHAJALAS COLLEGE, UNIVERSITY OF MYSORE</p>																																																																																																																																																																																																																																																																																																																																																													
<p>CLIENT : UNIVERSITY OF MYSORE</p>																																																																																																																																																																																																																																																																																																																																																													
<p>DRAWING TITLE</p>																																																																																																																																																																																																																																																																																																																																																													
<p>FIRST FLOOR PLAN</p>																																																																																																																																																																																																																																																																																																																																																													
<p>DRAWING - EXISTING PLAN</p>																																																																																																																																																																																																																																																																																																																																																													
<p>DATE : 15/11/2018</p>																																																																																																																																																																																																																																																																																																																																																													
<p>SCALE : 1/80</p>																																																																																																																																																																																																																																																																																																																																																													
<p>DATE: 15/11/2018</p>																																																																																																																																																																																																																																																																																																																																																													
<p>DESIGNED BY: ANISH</p>																																																																																																																																																																																																																																																																																																																																																													
<p>ARCHITECTURE</p>																																																																																																																																																																																																																																																																																																																																																													
<p>GRISH M SWAMIT CONSULTANTS</p>																																																																																																																																																																																																																																																																																																																																																													
<p>Committee, Architectural and Structural Engineers</p>																																																																																																																																																																																																																																																																																																																																																													
<p>100 Bg Bazaar, Mysore - 570002</p>																																																																																																																																																																																																																																																																																																																																																													
<p>Phone: 98453 22222</p>																																																																																																																																																																																																																																																																																																																																																													
<p>Mobile: 98453 22222</p>																																																																																																																																																																																																																																																																																																																																																													
<p>Website: www.grishm.com</p>																																																																																																																																																																																																																																																																																																																																																													

Annexure
2.1.5

Academic Calendar

Sl.No	Particular	Dates for 2018-19
1.	Admission	June-July
2.	Commencement of Academic Session for III and V Semester students	Mid-June
3.	Orientation and P.D.P. for Fresher Students	Last week of July
4.	Release of "Ananthayathri" Annual College Magazine	First week of August
5.	Annual Talent Search and Extra-Curricular activities Inaugural	Second week of August
6.	Inter-zonal Sports Meet for Men	Second week of September
7.	Centralised Internal assessment College Tests for Odd Semesters	Mid October
8.	Celebration of Karnataka Rajyothsava	First week of November
9.	Odd Semester Examinations	November – December
10.	Inter Collegiate Padmaja Prasad Memorial Music Competition	Mid January
11.	College level Dr. Rajkumar Memorial Music Competition	Mid January
12.	Centralised Internal Assessment Tests for Even Semesters	Last week of March
13.	Dr.B.R.Ambedkar Jayanthi celebration	Second week of April
14.	Valedictory Function/College Day	Last week of April

15.	Farewell to outgoing students	Last week of April
16.	Even Semester Examinations	May-June
17.	Educational Trips for Students	February to April
18.	One-day picnic for Staff	Second week of August and last week of January