

# Maharaja's College Mysuru



## Part – A

### 1. Details of the Institution

1.1 Name of the Institution

Maharaja's College

1.2 Address Line 1

JLB Road

Address Line 2

University of Mysore

City/Town

Mysuru

State

Karnataka

Pin Code

570005

Institution e-mail address

principalmcm1837@gmail.com

Contact Nos.

0821- 2419354 / 279

Name of the Head of the Institution:

Dr.B.Nagaraja Murthy

Tel. No. with STD Code:

0821- 2419 354 / 279

Mobile:

99026 34890

Name of the IQAC Co-ordinator:

Dr. Rohitha Eswer

Mobile:

98867 20924

IQAC e-mail address:

principalmcm1837@gmail.com

1.3 NAAC Track ID

KACOGN10130

1.4 Website address:

maharajas.uni-mysore.ac.in

Web-link of the AQAR:

http://maharajas.uni-mysore.ac.in/content/aqar-2014-15

1.5 Accreditation Details

Sl. No.	Cycle	Grade	CGPA	Year of Accreditation	Validity Period
1	1 <sup>st</sup> Cycle	4(****)	73.15	2001	05 Years
2	2 <sup>nd</sup> Cycle	--	--	---	---
3	3 <sup>rd</sup> Cycle	--	--	---	---
4	4 <sup>th</sup> Cycle	--	--	---	---

1.6 Date of Establishment of IQAC :

DD/MM/YYYY

02/ 08/2014

1.7 AQAR for the year (for example 2010-11)

2014-15

1.8 Details of the previous year's AQAR submitted to NAAC after the latest Assessment and Accreditation by NAAC

- i. AQAR \_\_\_\_\_ NA \_\_\_\_\_ (DD/MM/YYYY)  
ii. AQAR \_\_\_\_\_ NA \_\_\_\_\_ (DD/MM/YYYY)  
iii. AQAR \_\_\_\_\_ NA \_\_\_\_\_ (DD/MM/YYYY)  
iv. AQAR \_\_\_\_\_ NA \_\_\_\_\_ (DD/MM/YYYY)

1.9 Institutional Status

University  State  Central  Deemed  Private

Affiliated College Yes  No

Constituent College Yes  No

Autonomous college of UGC Yes  No

Regulatory Agency approved Institution Yes  No

Type of Institution Co-education  Men  Women

Urban  Rural  Tribal

Financial Status Grant-in-aid  UGC 2(f)  UGC 12B

Grant-in-aid + Self Financing  Totally Self-financing

1.10 Type of Faculty/Programme

Arts  Science  Commerce  Law  PEI (Phys Edu)

TEI (Edu)  Engineering  Health Science  Management

Others (Specify)

1.11 Name of the Affiliating University (for the Colleges)

1.12 Special status conferred by Central/ State Government-- UGC/CSIR/DST/DBT/ICMR etc :

Autonomy by State/Central Govt. / University

University with Potential for Excellence  UGC-CPE

DST Star Scheme  UGC-CE

UGC-Special Assistance Programme	<input type="text" value="No"/>	DST-FIST	<input type="text" value="No"/>
UGC-Innovative PG programmes	<input type="text" value="No"/>	any other ( <i>Specify</i> )	<input type="text" value="No"/>
UGC-COP Programmes	<input type="text" value="No"/>		

## **2. IQAC Composition and Activities**

2.1 No. of Teachers	<input type="text" value="05"/>
2.2 No. of Administrative/Technical staff	<input type="text" value="02"/>
2.3 No. of students	<input type="text" value="NIL"/>
2.4 No. of Management representatives	<input type="text" value="01"/>
2.5 No. of Alumni	<input type="text" value="NIL"/>
2.6 No. of any other stakeholder and Community representatives	<input type="text" value="NIL"/>
2.7 No. of Employers/ Industrialists	<input type="text" value="NIL"/>
2.8 No. of other External Experts	<input type="text" value="NIL"/>
2.9 Total No. of members	<input type="text" value="08"/>
2.10 No. of IQAC meetings held	<input type="text" value="03"/>

2.11 No. of meetings with various stakeholders: No.  Faculty   
 Non-Teaching Staff  Students  Alumni  Others

2.12 Has IQAC received any funding from UGC during the year? Yes  No

If yes, mention the amount

2.13 Seminars and Conferences (only quality related)

(i) No. of Seminars/Conferences/ Workshops/Symposia organized by the IQAC

Total Nos.  International  National  State  Institution Level

(ii) Themes

2.14 Significant Activities and contributions made by IQAC

Mudra Yoga for staff by Yogacharana Sri Shantharam
Exhibition of rare coins by Dr Rasheed
Regular meetings of the IQAC <ul style="list-style-type: none"> <li>• With teaching staff</li> <li>• With non-teaching staff</li> </ul>

## 2.15 Plan of Action by IQAC/Outcome

The plan of action chalked out by the IQAC in the beginning of the year towards quality Enhancement and the outcome achieved by the end of the year \*

Plan of Action	Achievements/Outcomes
<p>Planned to organize seminars, workshops and conferences</p>	<p>Organized One day Workshop on translation as an <i>Empowerment</i></p> <p>Organized Two day National level seminar on the <i>Contribution of</i></p> <p>Organized One day National Conference on the <i>Status of Geograph</i> February 2015.</p> <p>Organized National Seminar on <i>Theoretical Basis of the Modern C</i></p> <p>Organized Two day state level Seminar was organized to commemo with AVISHKARA, a cultural forum on 31<sup>st</sup> January and 1<sup>st</sup> February</p>
<p>Special talks to create awareness on various issues</p>	<p><b>Awareness programmes and rally's like :</b></p> <p>To create awareness on the freedom movement a Special talk on <i>Movement</i> on 24<sup>th</sup> March 2015</p> <p>On 13<sup>th</sup> March 2015 organized Special talk on <i>The Need for Women E</i></p> <p>Organized Special talk on <i>Heritage buildings of Mysore and social Va</i></p>

	Organized Special talk on <i>Women empowerment</i> on 13 <sup>th</sup> March 2015
	Organized Special Program on <i>Mudra Yoga for teaching and non-tea</i>
	Organized Special edition <i>Taliru</i> in which special five editions were
	Organized a rally on 8 <sup>th</sup> June 2014 to create <i>awareness on prevention</i>

\* Attach the Academic Calendar of the year as Annexure.

2.15 Whether the AQAR was placed in statutory body    Yes     No

Management     Syndicate     any other body

Provide the details of the action taken

NA

## Part – B

### Criterion – I

#### 1. Curricular Aspects

##### 1.1 Details about Academic Programmes

Level of the Programme	Number of existing Programmes	Number of programmes added during the year	Number of self-financing programmes	Number of value added / Career Oriented programmes
PhD	17	-	-	-
PG	01	-	-	-
UG	03	-	-	-
PG Diploma	-	-	-	-
Advanced Diploma	-	-	-	-
Diploma	-	-	-	-
Certificate	-	-	-	-
Others	-	-	-	-
<b>Total</b>	21	-	-	-
Interdisciplinary	03	-	-	-



Innovative	-	-	-	-
------------	---	---	---	---

(Ref: <http://maharajas.uni-mysore.ac.in/sites/default/files/courses-offered.PDF>)

- 1.2 (i) Flexibility of the Curriculum: CBCS/Core/Elective option / Open options  
(ii) Pattern of programmes:

Pattern	Number of programmes
Semester	04
Trimester	-
Annual	-

- 1.3 Feedback from stakeholders\* Alumni  Parents  Employers  Students   
*(On all aspects)*

Mode of feedback : Online  Manual  Co-operating schools (for PEI)

*\*Please provide an analysis of the feedback in the Annexure*

- 1.4 Whether there is any revision/update of regulation or syllabi, if yes, mention their salient aspects.

Periodic Revision in accordance with the University of Mysore

- 1.5 Any new Department/Centre introduced during the year. If yes, give details.

Nil

## Criterion – II

### 2. Teaching, Learning and Evaluation

2.1 Total No. of permanent faculty	Total	Asst. Professors	Associate Professors	Professors	Others
	53	27	26	-	-

2.2 No. of permanent faculty with Ph.D. 39

2.3 No. of Faculty Positions Recruited (R) and Vacant (V) during the year	Asst. Professors		Associate Professors		Professors		Others		Total	
	R	V	R	V	R	V	R	V	R	V
	-	-	-	-	-	-	-	-	Nil	42

2.4 No. of Guest and Visiting faculty and Temporary faculty 97 05 -

2.5 Faculty participation in conferences and symposia:

No. of Faculty	International level	National level	State level
Attended	28	54	18
Seminars/ Presented papers	17	15	01
Resource Persons	Nil	02	09

2.6 Innovative processes adopted by the institution in Teaching and Learning:

- The students are encouraged to make presentations on topics of their choice within a specific limited time period
- Students are taken on field visits, Hospitals, Industries, De-Addiction Centres, Prisons, Police Academies, Rehabilitation Centres, Slums, Tribal visits, etc., to have first hand information on their respective subjects
- Group discussions were conducted in classes for exchange of creative thoughts among the students; to develop communication skills, to overcome stage fear, to develop management and leadership skills
- Students of certain departments having ICT facilities were asked to prepare PPTs on a selected topic and were asked to present them in their class rooms
- Skill development activities for B.COM Course in respective individual subjects

2.7 Total No. of actual teaching days 186  
during this academic year

2.8 Examination/ Evaluation Reforms initiated by NA

the Institution (for example: Open Book Examination, Bar Coding, Double Valuation, Photocopy, Online Multiple Choice Questions)

2.9 No. of faculty members involved in curriculum restructuring/revision/syllabus development as member of Board of Study/Faculty/Curriculum Development workshop

07	-	-
----	---	---

2.10 Average percentage of attendance of students

75%
-----

2.11 Course/Programme wise Distribution of pass percentage :

Title of the Programme	Total no. of students appeared	Division				
		Distinction (%)	First Class (%)	Second class (%)	Third class (%)	Pass (%)
BA	568	2.28%	39.96%	18.97%	0.17%	51.41%
BBM	156	0.64%	21.79%	22.43%	1.92%	46.15%
B.Com.	219	12.32%	47.48%	13.24%	0.91%	73.97%
MSC in Criminology and Forensic Science	26	3.9%	65.4%	7.7%	00	77.0%

2.12 How does IQAC Contribute/Monitor/Evaluate the Teaching & Learning Processes:

- Centralized IA Time Table for UG Courses accommodating 22 Departments that include 147 papers spaced out in 6 days
- IQAC encourages teachers to accompany their students to get the first-hand knowledge of various topics of their curricula

Currently we follow the University pattern of 20:80 ratio, where 20 is IA and 80 End of Semester Exam

2.13 Initiatives undertaken towards faculty development

<i>Faculty / Staff Development Programmes</i>	<i>Number of faculty benefitted</i>
Refresher courses	09
UGC – Faculty Improvement Programme	-
HRD programmes	-
Orientation programmes	-
Faculty exchange programme	-
Staff training conducted by the university	-
Staff training conducted by other institutions	-
Summer / Winter schools, Workshops, etc.	-

Others	03
--------	----

#### 2.14 Details of Administrative and Technical staff

Category	Number of Permanent Employees	Number of Vacant Positions	Number of permanent positions filled during the Year	Number of positions filled temporarily
Administrative Staff	31	-	-	05
Technical Staff	01	-	-	-

### Criterion – III

### 3. Research, Consultancy and Extension

#### 3.1 Initiatives of the IQAC in Sensitizing/Promoting Research Climate in the institution

<ul style="list-style-type: none"> <li>• Few teachers apply for projects funded by UGC</li> <li>• Our College being a Research Centre has 27 recognized guides</li> <li>• Course work for research scholars in Kannada, Folklore, Criminology and Geography is conducted in the campus</li> <li>• The College sanctions OOD facilities and encourages faculty to present papers at National and International Conferences</li> </ul>
--

#### 3.2 Details regarding major projects

	Completed	Ongoing	Sanctioned	Submitted
Number	-	-	-	-
Outlay in Rs. Lakhs	-	-	-	-

#### 3.3 Details regarding minor projects

	Completed	Ongoing	Sanctioned	Submitted
Number	02	04	-	-
Outlay in Rs. Lakhs	2,05,000/-	3,30,000/-	-	-

#### 3.4 Details on research publications

	International	National	Others
Peer Review Journals	02	01	-
Non-Peer Review Journals	01	03	-
e-Journals	-	-	-
Conference proceedings	-	-	-

3.5 Details on Impact factor of publications:

Range  Average  h-index  Nos. in SCOPUS

3.6 Research funds sanctioned and received from various funding agencies, industry and other organisations

Nature of the Project	Duration Year	Name of the funding Agency	Total grant sanctioned	Received
Major projects	-	-	-	-
Minor Projects	-	-	-	-
Interdisciplinary Projects	-	-	-	-
Industry sponsored	-	-	-	-
Projects sponsored by the University/ College	-	-	-	-
Students research projects <i>(other than compulsory by the University)</i>	-	-	-	-
Any other(Specify)	-	-	-	-
Total	-	-	-	-

□

3.7 No. of books published i) With ISBN No.  Chapters in Edited Books

ii) Without ISBN No.

3.8 No. of University Departments receiving funds from

UGC-SAP  CAS  DST-FIST   
DPE  DBT Scheme/funds

3.9 For colleges Autonomy  CPE  DBT Star Scheme   
INSPIRE  CE  Any Other (specify)

3.10 Revenue generated through consultancy

3.11 No. of conferences organized by the Institution

Level	International	National	State	University	College
Number		03	01	01	
Sponsoring agencies		University of Mysore and State Bank of Mysore	Avishkar	University of Mysore and State Bank of Mysore	---

3.12 No. of faculty served as experts, chairpersons or resource persons

3.13 No. of collaborations International  National  Any other

3.14 No. of linkages created during this year

3.15 Total budget for research for current year in lakhs :

From funding agency  From Management of University/College

Total

3.16 No. of patents received this year

Type of Patent		Number
National	Applied	-
	Granted	-
International	Applied	-
	Granted	-
Commercialised	Applied	-
	Granted	-

3.17 No. of research awards/ recognitions received by faculty and research fellows  
Of the institute in the year

Total	International	National	State	University	Dist	College
02	-	01	-	-	01	-

3.18 No. of faculty from the Institution   
Who are Ph. D. Guides  
And students registered under them

3.19 No. of Ph.D. awarded by faculty from the Institution

3.20 No. of Research scholars receiving the Fellowships (Newly enrolled + existing ones)

JRF  SRF  Project Fellows  Any other

3.21 No. of students Participated in NSS events:

University level  State level   
National level  International level

3.22 No. of students participated in NCC events:

University level  State level   
National level  International level

3.23 No. of Awards won in NSS:

University level	<input type="text" value="07"/>	State level	<input type="text" value="--"/>
National level	<input type="text" value="--"/>	International level	<input type="text" value="--"/>

3.24 No. of Awards won in NCC:

University level	<input type="text" value="--"/>	State level	<input type="text" value="---"/>
National level	<input type="text" value="02"/>	International level	<input type="text" value="--"/>

3.25 No. of Extension activities organized

University forum	<input type="text" value="-"/>	College forum	<input type="text" value="34"/>
NCC	<input type="text" value="-"/>	NSS	<input type="text" value="-"/>
		Any other	<input type="text" value="-"/>

3.26 Major Activities during the year in the sphere of extension activities and Institutional Social Responsibility

- Celebrated 'Ekata Diwas on the day of integration day, where Jatha was organised to create awareness among public.
- Organised blood camp donor's registration camp
- HIV/Aids awareness programme was organised on 2/06/2015 (awareness campaign).
- Conducted annual social service camp at Hadinaru village Najangudu Tq. Mysuru District from 10/02/2015 to 16/02/2015.
- Swachhatha Andolana Jatha was organised to educate the public.
- Aids awareness Jatha organised by the two NSS units of Maharaja's college

## Criterion – IV

### 4. Infrastructure and Learning Resources

4.1 Details of increase in infrastructure facilities:

Facilities	Existing	Newly created	Source of Fund	Total
Campus area	1,40,424.43sq.mts	-	-	1,40,424.43sq.mts
Class rooms	52	-	-	52
Laboratories	07	-	-	07

Seminar Halls	03	-	-	03
No. of important equipments purchased ( $\geq$ 1-0 lakh) during the current year.	-	-	-	-
Value of the equipment purchased during the year (Rs. in Lakhs)	-	-	-	-
Others	-	-	-	-

#### 4.2 Computerization of administration and library

A special Computer Lab DRUSHTI is exclusively dedicated to the Visually Impaired students.

\*Students, Faculty and Research Scholars have access to 300 CDs, Videos, Journals and rare manuscripts.

#### 4.3 Library services:

	Existing		Newly added		Total	
	No.	Value	No.	Value	No.	Value
Text Books	191921	-	213	35000	192134	-
Reference Books	-	-	-	-	-	-
e-Books	98000	-	-	-	-	-
Journals	-	-	-	-	-	-
e-Journals	6000	-	-	5000	6000	5000
Digital Database	-	-	-	-	-	-
CD & Video	-	-	-	-	-	-
Others (specify)	-	-	-	-	-	-



#### 4.4 Technology up gradation (overall)

	Total Computers	Computer Labs	Internet	Browsing Centres	Computer Centres	Office	Departments	Others
Existing	30	02	Yes	-	01	05	10	-
Added	10	-	-	-	-	05	05	-
Total	40	02	-	-	01	10	15	-

#### 4.5 Computer, Internet access, training to teachers and students and any other programme for technology upgradation (Networking, e-Governance etc.)

Nil

#### 4.6 Amount spent on maintenance in lakhs :

i) ICT	-
ii) Campus Infrastructure and facilities	-
iii) Equipments	-
iv) Others	-
<b>Total :</b>	-

### Criterion – V

## 5. Student Support and Progression

#### 5.1 Contribution of IQAC in enhancing awareness about Student Support Services

- At the beginning of the Odd Semester a Personality Development Programme and Orientation Programme is conducted for Freshers
- All Notifications and Circulars received from University of Mysore regarding scholarships, and competitions are put up on the Notice Board

#### 5.2 Efforts made by the institution for tracking the progression

- Transfer Certificate Ledger helps track students' progression to higher education
- Department maintains record of all alumni who visit the department
- Teachers keep track via social media

#### 5.3 (a) Total Number of students

UG	PG	Ph. D.	Others
3072	54	151	-

(b) No. of students outside the state

(c) No. of international students

	No	%
Men	3023	94.48
Women	19	1.59

Last Year						This Year					
General	SC	ST	OBC	Physically Challenged	Total	General	SC	ST	OBC	Physically Challenged	Total
154	1437	291	1089	03	2974	109	1495	356	1105	01	3066

Demand ratio 1:1.58

Dropout 09%

5.4 Details of student support mechanism for coaching for competitive examinations (If any)

No. of students beneficiaries

5.5 No. of students qualified in these examinations

NET	<input type="text" value="10"/>	SET/SLET	<input type="text" value="01"/>	GATE	<input type="text" value="-"/>	CAT	<input type="text" value="-"/>
IAS/IPS etc	<input type="text" value="-"/>	State PSC	<input type="text" value="-"/>	UPSC	<input type="text" value="-"/>	Others	<input type="text" value="-"/>

5.6 Details of student counselling and career guidance

1. 'VISTA mind career' oriented students on 'awareness on various competitive examinations for MBA/MCA and conducted campus recruitment on 20-2-2015 for B.Com and BBA students

2. Dr. Reddy's foundation conducted a programme on Institutional skills from 23-2-2015 to 26-2-2015

No. of students benefitted

5.7 Details of campus placement

<i>On campus</i>			<i>Off Campus</i>
Number of Organizations Visited	Number of Students Participated	Number of Students Placed	Number of Students Placed
-	-	-	-

### 5.8 Details of gender sensitization programmes

- On 13/3/2015 organized a special talk on *The Need for Women Empowerment*
- A rally was organized on 8<sup>th</sup> June 2014 to create awareness on *Prevention of Harassment to Women*

### 5.9 Students Activities

#### 5.9.1 No. of students participated in Sports, Games and other events

State/ University level  National level  International level

#### No. of students participated in cultural events

State/ University level  National level  International level

5.9.2 No. of medals /awards won by students in Sports, Games and other events

Sports: State/ University level  National level  International level

Cultural: State/ University level  National level  International level

### 5.10 Scholarships and Financial Support

	Number of students	Amount
Financial support from institution	-	-
Financial support from government	2598	Rs.1,20,22,524/-
Financial support from other sources	-	-
Number of students who received International/ National recognitions	-	-

### 5.11 Student organised / initiatives

Fairs : State/ University level  National level  International level

Exhibition: State/ University level  National level  International level

5.12 No. of social initiatives undertaken by the students

5.13 Major grievances of students (if any) redressed: No Grievances

## Criterion – VI

### **6. Governance, Leadership and Management**

#### 6.1 State the Vision and Mission of the institution

- “Value based education for a value-based society”
- To provide opportunities for individuals from diverse backgrounds to pursue their educational goals.
- To offer educational programmes that are affordable and accessible to all.
- To focus on learning-learners to receive quality education and services that foster students’ success in achievement of their stated goal.
- To demonstrate a respect for differences and an appreciation of multiple perspective
- To strive to mould them into responsible and successful citizens.

#### 6.2 Does the Institution has a management Information System

No

### 6.3 Quality improvement strategies adopted by the institution for each of the following:

#### 6.3.1 Curriculum Development

- Twenty one teachers are on the Board of Studies of both UG and PG Courses of the University of Mysore. The members are largely involved in the revision of syllabus to cater to the needs of the students for their career growth. Whenever there is a change in the syllabus, teachers of such departments sit together at the beginning of the semester and plan out how the changes have to be incorporated and dealt with in the class.
- Each department finds different ways other than class room teaching alone to give a holistic approach to the subject.
- The Curriculum is thus carried out in such a manner to complete the syllabus well in time.

#### 6.3.2 Teaching and Learning

- Highly qualified (39 with Ph.D.) and dedicated faculty
- Students are encouraged to make presentations on topics of their choice within a specific limited time period during the class hours
- Students are taken on field visits, Hospitals, Industries, De-Addiction Centres, Prisons, Police Academies, Govt. Offices, Rehabilitation Centres, Slums, Tribal visits, etc., to have first hand information in their respective subjects
- Group discussions were conducted in classes for exchange of creative thoughts among the students; to develop communication skills, to overcome stage fear, to develop management and leadership skills. Students of certain departments having ICT facilities were asked to prepare PPTs on a selected topic and present them in their class rooms

#### 6.3.3 Examination and Evaluation

- Continuous evaluation is through different methods like internal assessment test, assignments, group discussion, seminars etc.
- Transparency is maintained in the evaluation process. Blue books are assessed and returned to the students. If there are any grievances students are encouraged to meet the individual teacher and the Head of the Department and the issue is resolved. If any discrepancy in IA marks is found by the student, once it is uploaded on the University Web site, such cases are addressed through the examination section of the College.

#### 6.3.4 Research and Development

- Few teachers apply for Projects funded by UGC
- Our College being a Research Centre has 27 recognized guides
- Course work for Research Scholars are conducted in the campus
- The College sanctions OOD facilities and encourages faculty to present papers at National and International Conferences

#### 6.3.5 Library, ICT and physical infrastructure / instrumentation

- Library, housed in a separate heritage building
- A special Computer Lab DRUSHTI is exclusively dedicated to the Visually Impaired students
- Library has more than 1, 90,000 books which include Text Books as well as Reference books
- Students, Faculty and Research Scholars have access to 300 CDs, Videos, Journals and rare manuscripts
- Photo copying facility available
- 24x7 Wi-Fi facility is available in the library.
- 52 classrooms, 07 Labs and 03 Seminar Halls
- 03 classrooms with ICT facility

#### 6.3.6 Human Resource Management

- A well chalked out Time Table makes sure that 92 % of our students have no waiting time between classes
- Lunch breaks are staggered for BA and Commerce Classes
- All such departments where the teaching faculty have registered for PhD and are expected to complete the course work, which is held on Saturdays, are allotted classes in such a manner that they are free on Saturdays

#### 6.3.7 Faculty and Staff recruitment

### 6.3.8 Industry Interaction / Collaboration

- Though no formal industry interaction takes place, at individual level, teachers who have contacts introduce students to Managements and Industrialists of their respective and related fields

### 6.3.9 Admission of Students

- Admission of students is through a very transparent process. The prospectus and the application form are priced very moderately
- SSP software is used for short listing the students based on the prescribed reservation policy of the Govt. Of Karnataka cum merit

### 6.4 Welfare schemes for

Teaching	Yes
Non teaching	Yes
Students	Yes

### 6.5 Total corpus fund generated

NIL

### 6.6 Whether annual financial audit has been done

Yes  No

### 6.7 Whether Academic and Administrative Audit (AAA) has been done?

Audit Type	External		Internal	
	Yes/No	Agency	Yes/No	Authority
Academic	No	-	No	-
Administrative	No	-	No	-

### 6.8 Does the University/ Autonomous College declare results within 30 days? NA

For UG Programmes Yes  No

For PG Programmes Yes  No

6.9 What efforts are made by the University/ Autonomous College for Examination Reforms?

NA

6.10 What efforts are made by the University to promote autonomy in the affiliated/constituent colleges?

NA

6.11 Activities and support from the Alumni Association

Nil

6.12 Activities and support from the Parent – Teacher Association

-

6.13 Development programmes for support staff

-

6.14 Initiatives taken by the institution to make the campus eco-friendly

- Medical waste from the health centre is segregated and disposed off separately
- Planting of trees
- A Samvadavana surrounded by greenery, created using recycled material
- 

## **Criterion – VII\_**

### **7. Innovations and Best Practices**

7.1 Innovations introduced during this academic year which have created a positive impact on the Functioning of the institution. Give details.

- Exhibitions open to the general public
- DRUSTI Lab for visually impaired



7.2 Provide the Action Taken Report (ATR) based on the plan of action decided upon at the Beginning of the year

Five workshops/conferences, 7 awareness programmes and rallies were organized successfully.

7.3 Give two Best Practices of the institution (*please see the format in the NAAC Self-study Manuals*)

- 1) Introduction of Biometric attendance
- 2) Closed circuit television with 18 cameras to monitor discipline and functioning of the office

•

***\*Provide the details in annexure (annexure need to be numbered as i, ii,iii)***

7.4 Contribution to environmental awareness / protection

- Trees and bushes with identification boards
- Fencing with hedges

7.5 Whether environmental audit was conducted?

Yes

No

7.6 Any other relevant information the institution wishes to add. (For example SWOT Analysis)

<b>SL NO</b>	<b>STRENGTHS</b>	<b>SL NO</b>	<b>WEAKNESS</b>
1	Located in the centre of the city and easily accessible	1	No financial autonomy
2	Being a Constituent College, well supported by the University of Mysore	2	No appointment of permanent faculty since 2007
3	Adequate hostel facilities for students	3	Delayed appointment of guest faculty at the beginning of the odd semester
4	Moderate fee structure		
5	A good number of highly qualified teachers, with over 90% holding doctoral degrees.		
6	Good facilities for Sports, NSS & NCC		
7	A century old library, with large number of books on variety of subjects		
8	In house health centre, indoor gymnasium, tennis courts and information centre.		
9	Unusual and rare subjects with unique combinations are offered		
	<b>OPPORTUNITIES</b>		<b>THREATS</b>
1	Scope for expansion of PG courses	1	Achieving a better overall pass percentages
2	Large number of Research Guides & Research Scholars, Hence, there is scope for improvement in research activities	2	Shortage of class rooms
3	With good facilities for sports, NSS & NCC opportunities for students to excel.	3	Largely dependent on guest faculty and contractual staff

## 8. Plans of institution for next year

- Planned to organize seminars, workshops and conferences
- To create awareness through rallies and jathas regarding various issues
- Planned to organize special lectures

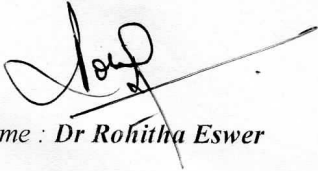

Name : **Dr Rohitha Eswer**

Sd/-

*Signature of the Coordinator, IQAC*

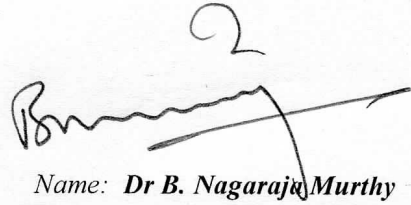

Name: **Dr B. Nagaraja Murthy**

Sd/-

*Signature of the Chairperson, IQAC*

\*\*\*

*www.ugc.ac.in*

*PRINCIPAL*  
*Maharaja's College*  
*University of Mysore*  
*570 005*

### Universities & Colleges

- Colleges Under Section 2(f) & 12(B)
- Autonomous Colleges
- Colleges With Potential for Excellence
- Academic Staff Colleges
- Universities (UPE)
- Centres (CPEPA)
- Basic Scientific Research
- Visiting Committee Reports
- Central Universities
- State Universities List
- Deemed Universities
- Private Universities
- Fake Universities

#### Colleges under section 2(f) & 12(B) of the UGC Act 1956

##### Consolidated List of Colleges under section 2(f)/12(B)

The University Grants Commission (UGC) provides financial assistance to eligible colleges which are included under Section 2(f)\* and declared fit to receive central assistance (UGC grant) under Section 12 (B)\*\* of UGC Act, 1956 as per approved pattern of assistance under various schemes.

\* The UGC had notified Regulations for recognition of colleges under Section 2(f) of the UGC Act, 1956. The colleges are brought under the purview of UGC in terms of these Regulations as and when the proposals are received from the colleges for inclusion under Section 2(f) and they are found fit for inclusion as per the provisions contained in the Regulations.

\*\* Apart from inclusion of colleges under Section 2(f), the UGC includes the Colleges under Section 12(B) of its Act in terms of Rules framed under the Act. This makes the colleges eligible for central assistance from the Government of India or any organization receiving funds from the Central Government.

#### For Students

- About NET | UGC NET Online
- Ragging Related Circulars
- Fake Universities | Educational Loan

#### For Faculty

- Honours and Awards | UGC Regulations
- Pay Related Orders | M R P
- Faculty Recharge | Faculty Development

#### MORE

- Notices | Circulars | Tenders | Jobs |
- UGC ROs | Right to Information Act
- Other Higher Education Links
- Contact

### Annexure:

www.ugc.ac.in/colleges/

*Principal*  
PRINCIPAL

Mysore University, Mysore

Name and address of the college	Status	Year of Estb.	Nature of Affiliation	Teaching Upto	Govt or Non Govt	Aided or Unaided
<b>J.S.S. College</b> Gundalpet Dist. Chamaraja Nagar - 571 111 Karnataka	2(f) and 12(B)	1983	Permanent	Bachelor's	Non Government	
<b>J.S.S. College for Women</b> Kollegal Dist. Mysore - 571 440 Karnataka	2(f) and 12(B)	1983	Permanent	Bachelor's	Non Government	
<b>J.S.S. College for Women (Autonomous)</b> Saraswathipuram Mysore 570 009 Karnataka	2(f) and 12(B)	1954	Permanent	Bachelor's	Non Government	
<b>J.S.S. College of Arts, Commerce &amp; Science</b> Saraswathipuram Dist. Mysore - 9 Karnataka	2(f) and 12(B)	1970	Permanent	Bachelor's	Non Government	
<b>J.S.S. College of Arts, Commerce &amp; Science</b> Chamarajanagar Dist. Chamaraja Nagar - 571 313 Karnataka	2(f) and 12(B)	1967	Permanent	Bachelor's	Non Government	
<b>J.S.S. College of Arts, Science and Commerce</b> Ooty Road Dist. Mysore - 570 004 Karnataka	2(f) and 12(B)	1964	Permanent	Bachelor's	Non Government	
<b>J.S.S. Law College</b> Kuvempunagar Dist. Mysore - 570 023 Karnataka	2(f) and 12(B)	1982	Permanent	Bachelor's	Non Government	
<b>JSS Institute of Speech and Hearing</b> Ooty Road Mysore - 570 025 Karnataka	2(f)	2001	Temporary	Master's	Non Government	Unaided
<b>M. Krishna Law College</b> Hassan Dist. Hassan - 573 201 Karnataka	2(f) and 12(B)	1974	Permanent	Bachelor's	Non Government	
<b>Maharaja's College</b> Mysore Dist. Mysore - 570 005 Karnataka	2(f) and 12(B)	1837	Permanent	Bachelor's	Government	

As on 30.11.2015

CPP-I/C

Page 418 of 1265

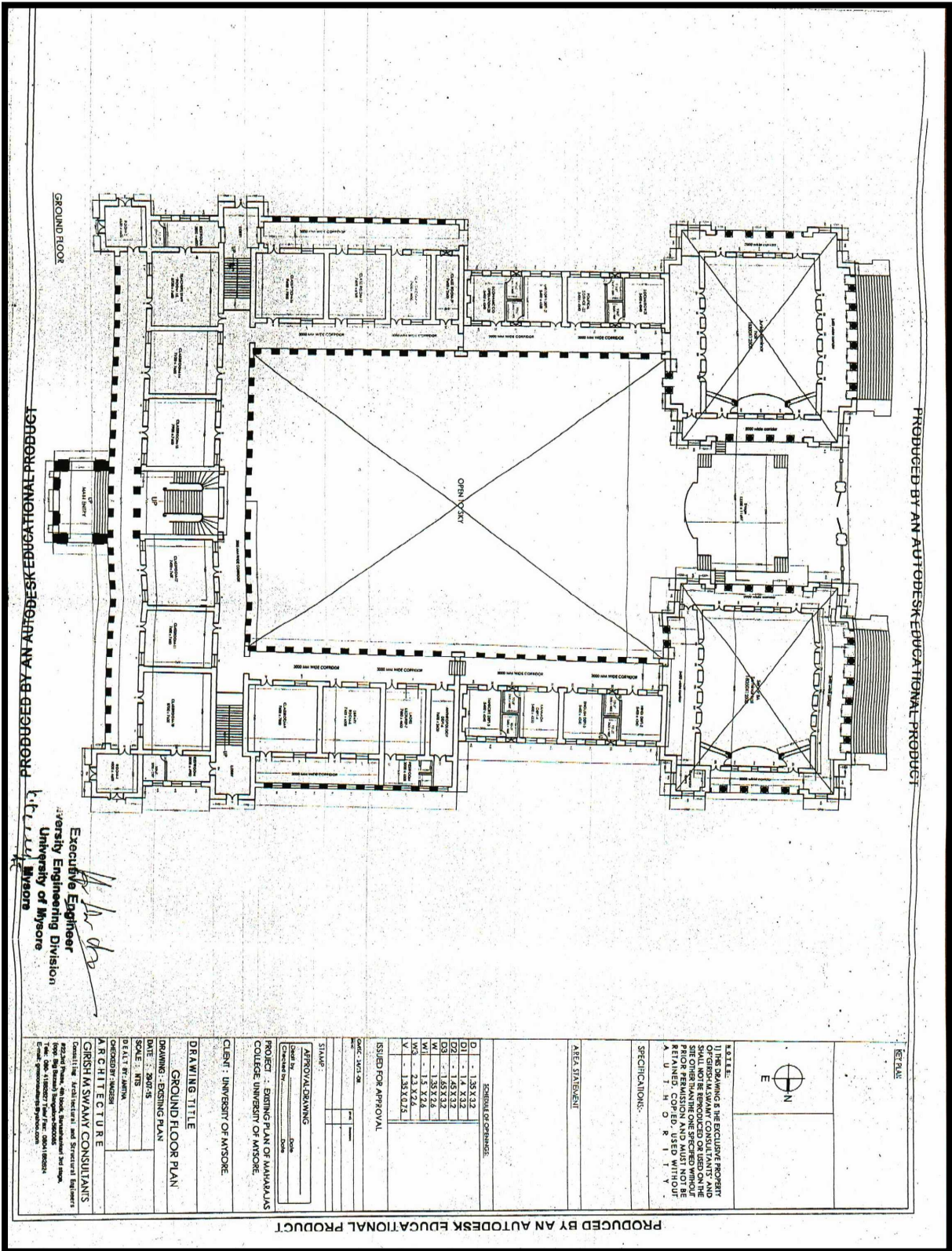

PRODUCED BY AN AUTODESK EDUCATIONAL PRODUCT

PRODUCED BY AN AUTODESK EDUCATIONAL PRODUCT

*[Signature]*  
 Executive Engineer  
 University of Mysore  
 Mysore

<p>DATE: 20/07/15</p> <p>SCALE: 1/8</p> <p>DRAWN BY: JAYANATH</p> <p>CHECKED BY: JAYANATH</p> <p>DESIGNED BY: JAYANATH</p> <p>PROJECT: ENGINEERING PLAN OF MAYAVALUJAS COLLEGE, UNIVERSITY OF MYSORE.</p> <p>CLIENT: UNIVERSITY OF MYSORE.</p>		<p><b>AREA STATEMENT</b></p>	<p><b>SCHEDULE OF CHANGES:</b></p> <table border="1"> <tr><td>D1</td><td>-</td><td>1.35 X 3.12</td></tr> <tr><td>D2</td><td>-</td><td>1.45 X 3.12</td></tr> <tr><td>D3</td><td>-</td><td>1.65 X 3.12</td></tr> <tr><td>M1</td><td>-</td><td>1.38 X 2.6</td></tr> <tr><td>M2</td><td>-</td><td>1.5 X 2.6</td></tr> <tr><td>V</td><td>-</td><td>1.35 X 2.2</td></tr> </table>	D1	-	1.35 X 3.12	D2	-	1.45 X 3.12	D3	-	1.65 X 3.12	M1	-	1.38 X 2.6	M2	-	1.5 X 2.6	V	-	1.35 X 2.2	<p><b>NOTES:</b></p> <p>1] THIS DRAWING IS THE EXCLUSIVE PROPERTY OF GIRISH M SWAMY CONSULTANTS AND SITE OTHER THAN THE ONE SPECIFIED WITHOUT PRIOR PERMISSION AND MUST NOT BE REPRODUCED OR USED WITHOUT PERMISSION.</p>
D1	-	1.35 X 3.12																				
D2	-	1.45 X 3.12																				
D3	-	1.65 X 3.12																				
M1	-	1.38 X 2.6																				
M2	-	1.5 X 2.6																				
V	-	1.35 X 2.2																				
<p><b>DRAWING TITLE</b></p> <p>GROUND FLOOR PLAN</p> <p>DRAWING: EXISTING PLAN</p>		<p><b>SPECIFICATIONS:</b></p>																				
<p><b>CLIENT: UNIVERSITY OF MYSORE.</b></p>																						
<p><b>PROJECT: ENGINEERING PLAN OF MAYAVALUJAS COLLEGE, UNIVERSITY OF MYSORE.</b></p>																						
<p><b>CLIENT: UNIVERSITY OF MYSORE.</b></p>																						
<p><b>DRAWING TITLE</b></p> <p>GROUND FLOOR PLAN</p> <p>DRAWING: EXISTING PLAN</p> <p>DATE: 20/07/15</p> <p>SCALE: 1/8</p> <p>DRAWN BY: JAYANATH</p> <p>CHECKED BY: JAYANATH</p> <p>DESIGNED BY: JAYANATH</p> <p><b>GIRISH M SWAMY CONSULTANTS</b>          Civil/IT/ing. Architects and Structural Engineers          2nd Floor, 4th Block, Banashankari 3rd Stage,          Bangalore - 560075          Tel: 080-11800077 Fax: 080-11800034          Email: gms@gsmswamyconsultants.com</p>																						

PRODUCED BY AN AUTODESK EDUCATIONAL PRODUCT

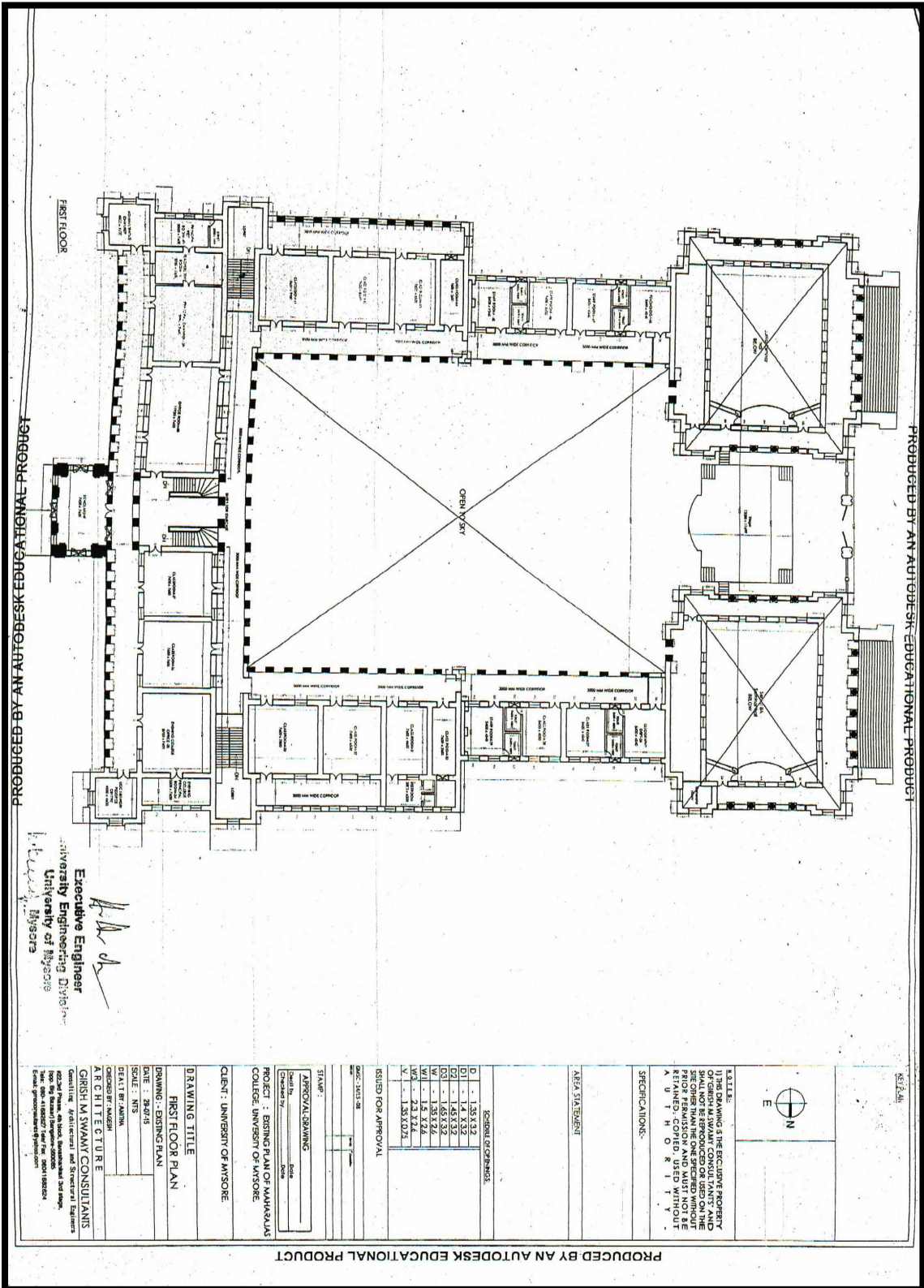

Executive Engineer  
 University Engineering Division  
 Mysore  
 University of Mysore  
 Mysore

<p>NOTE:</p> <p>1) THE DRAWING IS THE EXCLUSIVE PROPERTY OF THE ARCHITECT AND SHALL NOT BE REPRODUCED OR USED ON THE SITE OTHER THAN THE ONE SPECIFIED WITHOUT THE WRITTEN PERMISSION OF THE ARCHITECT.</p>																																																																																																																																																																																																																	
<p>SCALE:</p> <p>1:100</p>																																																																																																																																																																																																																	
<p>AREA STATEMENT</p>																																																																																																																																																																																																																	
<p>SCHEDULE OF COSTS:</p> <table border="1"> <tr><td>D</td><td>1.35 X 3.2</td></tr> <tr><td>D1</td><td>1.4 X 3.2</td></tr> <tr><td>D2</td><td>1.45 X 3.2</td></tr> <tr><td>W</td><td>1.35 X 2.6</td></tr> <tr><td>W1</td><td>1.5 X 2.6</td></tr> <tr><td>W2</td><td>1.5 X 2.6</td></tr> <tr><td>W3</td><td>1.5 X 2.6</td></tr> <tr><td>W4</td><td>1.5 X 2.6</td></tr> <tr><td>W5</td><td>1.5 X 2.6</td></tr> <tr><td>W6</td><td>1.5 X 2.6</td></tr> <tr><td>W7</td><td>1.5 X 2.6</td></tr> <tr><td>W8</td><td>1.5 X 2.6</td></tr> <tr><td>W9</td><td>1.5 X 2.6</td></tr> <tr><td>W10</td><td>1.5 X 2.6</td></tr> <tr><td>W11</td><td>1.5 X 2.6</td></tr> <tr><td>W12</td><td>1.5 X 2.6</td></tr> <tr><td>W13</td><td>1.5 X 2.6</td></tr> <tr><td>W14</td><td>1.5 X 2.6</td></tr> <tr><td>W15</td><td>1.5 X 2.6</td></tr> <tr><td>W16</td><td>1.5 X 2.6</td></tr> <tr><td>W17</td><td>1.5 X 2.6</td></tr> <tr><td>W18</td><td>1.5 X 2.6</td></tr> <tr><td>W19</td><td>1.5 X 2.6</td></tr> <tr><td>W20</td><td>1.5 X 2.6</td></tr> <tr><td>W21</td><td>1.5 X 2.6</td></tr> <tr><td>W22</td><td>1.5 X 2.6</td></tr> <tr><td>W23</td><td>1.5 X 2.6</td></tr> <tr><td>W24</td><td>1.5 X 2.6</td></tr> <tr><td>W25</td><td>1.5 X 2.6</td></tr> <tr><td>W26</td><td>1.5 X 2.6</td></tr> <tr><td>W27</td><td>1.5 X 2.6</td></tr> <tr><td>W28</td><td>1.5 X 2.6</td></tr> <tr><td>W29</td><td>1.5 X 2.6</td></tr> <tr><td>W30</td><td>1.5 X 2.6</td></tr> <tr><td>W31</td><td>1.5 X 2.6</td></tr> <tr><td>W32</td><td>1.5 X 2.6</td></tr> <tr><td>W33</td><td>1.5 X 2.6</td></tr> <tr><td>W34</td><td>1.5 X 2.6</td></tr> <tr><td>W35</td><td>1.5 X 2.6</td></tr> <tr><td>W36</td><td>1.5 X 2.6</td></tr> <tr><td>W37</td><td>1.5 X 2.6</td></tr> <tr><td>W38</td><td>1.5 X 2.6</td></tr> <tr><td>W39</td><td>1.5 X 2.6</td></tr> <tr><td>W40</td><td>1.5 X 2.6</td></tr> <tr><td>W41</td><td>1.5 X 2.6</td></tr> <tr><td>W42</td><td>1.5 X 2.6</td></tr> <tr><td>W43</td><td>1.5 X 2.6</td></tr> <tr><td>W44</td><td>1.5 X 2.6</td></tr> <tr><td>W45</td><td>1.5 X 2.6</td></tr> <tr><td>W46</td><td>1.5 X 2.6</td></tr> <tr><td>W47</td><td>1.5 X 2.6</td></tr> <tr><td>W48</td><td>1.5 X 2.6</td></tr> <tr><td>W49</td><td>1.5 X 2.6</td></tr> <tr><td>W50</td><td>1.5 X 2.6</td></tr> <tr><td>W51</td><td>1.5 X 2.6</td></tr> <tr><td>W52</td><td>1.5 X 2.6</td></tr> <tr><td>W53</td><td>1.5 X 2.6</td></tr> <tr><td>W54</td><td>1.5 X 2.6</td></tr> <tr><td>W55</td><td>1.5 X 2.6</td></tr> <tr><td>W56</td><td>1.5 X 2.6</td></tr> <tr><td>W57</td><td>1.5 X 2.6</td></tr> <tr><td>W58</td><td>1.5 X 2.6</td></tr> <tr><td>W59</td><td>1.5 X 2.6</td></tr> <tr><td>W60</td><td>1.5 X 2.6</td></tr> <tr><td>W61</td><td>1.5 X 2.6</td></tr> <tr><td>W62</td><td>1.5 X 2.6</td></tr> <tr><td>W63</td><td>1.5 X 2.6</td></tr> <tr><td>W64</td><td>1.5 X 2.6</td></tr> <tr><td>W65</td><td>1.5 X 2.6</td></tr> <tr><td>W66</td><td>1.5 X 2.6</td></tr> <tr><td>W67</td><td>1.5 X 2.6</td></tr> <tr><td>W68</td><td>1.5 X 2.6</td></tr> <tr><td>W69</td><td>1.5 X 2.6</td></tr> <tr><td>W70</td><td>1.5 X 2.6</td></tr> <tr><td>W71</td><td>1.5 X 2.6</td></tr> <tr><td>W72</td><td>1.5 X 2.6</td></tr> <tr><td>W73</td><td>1.5 X 2.6</td></tr> <tr><td>W74</td><td>1.5 X 2.6</td></tr> <tr><td>W75</td><td>1.5 X 2.6</td></tr> <tr><td>W76</td><td>1.5 X 2.6</td></tr> <tr><td>W77</td><td>1.5 X 2.6</td></tr> <tr><td>W78</td><td>1.5 X 2.6</td></tr> <tr><td>W79</td><td>1.5 X 2.6</td></tr> <tr><td>W80</td><td>1.5 X 2.6</td></tr> <tr><td>W81</td><td>1.5 X 2.6</td></tr> <tr><td>W82</td><td>1.5 X 2.6</td></tr> <tr><td>W83</td><td>1.5 X 2.6</td></tr> <tr><td>W84</td><td>1.5 X 2.6</td></tr> <tr><td>W85</td><td>1.5 X 2.6</td></tr> <tr><td>W86</td><td>1.5 X 2.6</td></tr> <tr><td>W87</td><td>1.5 X 2.6</td></tr> <tr><td>W88</td><td>1.5 X 2.6</td></tr> <tr><td>W89</td><td>1.5 X 2.6</td></tr> <tr><td>W90</td><td>1.5 X 2.6</td></tr> <tr><td>W91</td><td>1.5 X 2.6</td></tr> <tr><td>W92</td><td>1.5 X 2.6</td></tr> <tr><td>W93</td><td>1.5 X 2.6</td></tr> <tr><td>W94</td><td>1.5 X 2.6</td></tr> <tr><td>W95</td><td>1.5 X 2.6</td></tr> <tr><td>W96</td><td>1.5 X 2.6</td></tr> <tr><td>W97</td><td>1.5 X 2.6</td></tr> <tr><td>W98</td><td>1.5 X 2.6</td></tr> <tr><td>W99</td><td>1.5 X 2.6</td></tr> <tr><td>W100</td><td>1.5 X 2.6</td></tr> </table>		D	1.35 X 3.2	D1	1.4 X 3.2	D2	1.45 X 3.2	W	1.35 X 2.6	W1	1.5 X 2.6	W2	1.5 X 2.6	W3	1.5 X 2.6	W4	1.5 X 2.6	W5	1.5 X 2.6	W6	1.5 X 2.6	W7	1.5 X 2.6	W8	1.5 X 2.6	W9	1.5 X 2.6	W10	1.5 X 2.6	W11	1.5 X 2.6	W12	1.5 X 2.6	W13	1.5 X 2.6	W14	1.5 X 2.6	W15	1.5 X 2.6	W16	1.5 X 2.6	W17	1.5 X 2.6	W18	1.5 X 2.6	W19	1.5 X 2.6	W20	1.5 X 2.6	W21	1.5 X 2.6	W22	1.5 X 2.6	W23	1.5 X 2.6	W24	1.5 X 2.6	W25	1.5 X 2.6	W26	1.5 X 2.6	W27	1.5 X 2.6	W28	1.5 X 2.6	W29	1.5 X 2.6	W30	1.5 X 2.6	W31	1.5 X 2.6	W32	1.5 X 2.6	W33	1.5 X 2.6	W34	1.5 X 2.6	W35	1.5 X 2.6	W36	1.5 X 2.6	W37	1.5 X 2.6	W38	1.5 X 2.6	W39	1.5 X 2.6	W40	1.5 X 2.6	W41	1.5 X 2.6	W42	1.5 X 2.6	W43	1.5 X 2.6	W44	1.5 X 2.6	W45	1.5 X 2.6	W46	1.5 X 2.6	W47	1.5 X 2.6	W48	1.5 X 2.6	W49	1.5 X 2.6	W50	1.5 X 2.6	W51	1.5 X 2.6	W52	1.5 X 2.6	W53	1.5 X 2.6	W54	1.5 X 2.6	W55	1.5 X 2.6	W56	1.5 X 2.6	W57	1.5 X 2.6	W58	1.5 X 2.6	W59	1.5 X 2.6	W60	1.5 X 2.6	W61	1.5 X 2.6	W62	1.5 X 2.6	W63	1.5 X 2.6	W64	1.5 X 2.6	W65	1.5 X 2.6	W66	1.5 X 2.6	W67	1.5 X 2.6	W68	1.5 X 2.6	W69	1.5 X 2.6	W70	1.5 X 2.6	W71	1.5 X 2.6	W72	1.5 X 2.6	W73	1.5 X 2.6	W74	1.5 X 2.6	W75	1.5 X 2.6	W76	1.5 X 2.6	W77	1.5 X 2.6	W78	1.5 X 2.6	W79	1.5 X 2.6	W80	1.5 X 2.6	W81	1.5 X 2.6	W82	1.5 X 2.6	W83	1.5 X 2.6	W84	1.5 X 2.6	W85	1.5 X 2.6	W86	1.5 X 2.6	W87	1.5 X 2.6	W88	1.5 X 2.6	W89	1.5 X 2.6	W90	1.5 X 2.6	W91	1.5 X 2.6	W92	1.5 X 2.6	W93	1.5 X 2.6	W94	1.5 X 2.6	W95	1.5 X 2.6	W96	1.5 X 2.6	W97	1.5 X 2.6	W98	1.5 X 2.6	W99	1.5 X 2.6	W100	1.5 X 2.6
D	1.35 X 3.2																																																																																																																																																																																																																
D1	1.4 X 3.2																																																																																																																																																																																																																
D2	1.45 X 3.2																																																																																																																																																																																																																
W	1.35 X 2.6																																																																																																																																																																																																																
W1	1.5 X 2.6																																																																																																																																																																																																																
W2	1.5 X 2.6																																																																																																																																																																																																																
W3	1.5 X 2.6																																																																																																																																																																																																																
W4	1.5 X 2.6																																																																																																																																																																																																																
W5	1.5 X 2.6																																																																																																																																																																																																																
W6	1.5 X 2.6																																																																																																																																																																																																																
W7	1.5 X 2.6																																																																																																																																																																																																																
W8	1.5 X 2.6																																																																																																																																																																																																																
W9	1.5 X 2.6																																																																																																																																																																																																																
W10	1.5 X 2.6																																																																																																																																																																																																																
W11	1.5 X 2.6																																																																																																																																																																																																																
W12	1.5 X 2.6																																																																																																																																																																																																																
W13	1.5 X 2.6																																																																																																																																																																																																																
W14	1.5 X 2.6																																																																																																																																																																																																																
W15	1.5 X 2.6																																																																																																																																																																																																																
W16	1.5 X 2.6																																																																																																																																																																																																																
W17	1.5 X 2.6																																																																																																																																																																																																																
W18	1.5 X 2.6																																																																																																																																																																																																																
W19	1.5 X 2.6																																																																																																																																																																																																																
W20	1.5 X 2.6																																																																																																																																																																																																																
W21	1.5 X 2.6																																																																																																																																																																																																																
W22	1.5 X 2.6																																																																																																																																																																																																																
W23	1.5 X 2.6																																																																																																																																																																																																																
W24	1.5 X 2.6																																																																																																																																																																																																																
W25	1.5 X 2.6																																																																																																																																																																																																																
W26	1.5 X 2.6																																																																																																																																																																																																																
W27	1.5 X 2.6																																																																																																																																																																																																																
W28	1.5 X 2.6																																																																																																																																																																																																																
W29	1.5 X 2.6																																																																																																																																																																																																																
W30	1.5 X 2.6																																																																																																																																																																																																																
W31	1.5 X 2.6																																																																																																																																																																																																																
W32	1.5 X 2.6																																																																																																																																																																																																																
W33	1.5 X 2.6																																																																																																																																																																																																																
W34	1.5 X 2.6																																																																																																																																																																																																																
W35	1.5 X 2.6																																																																																																																																																																																																																
W36	1.5 X 2.6																																																																																																																																																																																																																
W37	1.5 X 2.6																																																																																																																																																																																																																
W38	1.5 X 2.6																																																																																																																																																																																																																
W39	1.5 X 2.6																																																																																																																																																																																																																
W40	1.5 X 2.6																																																																																																																																																																																																																
W41	1.5 X 2.6																																																																																																																																																																																																																
W42	1.5 X 2.6																																																																																																																																																																																																																
W43	1.5 X 2.6																																																																																																																																																																																																																
W44	1.5 X 2.6																																																																																																																																																																																																																
W45	1.5 X 2.6																																																																																																																																																																																																																
W46	1.5 X 2.6																																																																																																																																																																																																																
W47	1.5 X 2.6																																																																																																																																																																																																																
W48	1.5 X 2.6																																																																																																																																																																																																																
W49	1.5 X 2.6																																																																																																																																																																																																																
W50	1.5 X 2.6																																																																																																																																																																																																																
W51	1.5 X 2.6																																																																																																																																																																																																																
W52	1.5 X 2.6																																																																																																																																																																																																																
W53	1.5 X 2.6																																																																																																																																																																																																																
W54	1.5 X 2.6																																																																																																																																																																																																																
W55	1.5 X 2.6																																																																																																																																																																																																																
W56	1.5 X 2.6																																																																																																																																																																																																																
W57	1.5 X 2.6																																																																																																																																																																																																																
W58	1.5 X 2.6																																																																																																																																																																																																																
W59	1.5 X 2.6																																																																																																																																																																																																																
W60	1.5 X 2.6																																																																																																																																																																																																																
W61	1.5 X 2.6																																																																																																																																																																																																																
W62	1.5 X 2.6																																																																																																																																																																																																																
W63	1.5 X 2.6																																																																																																																																																																																																																
W64	1.5 X 2.6																																																																																																																																																																																																																
W65	1.5 X 2.6																																																																																																																																																																																																																
W66	1.5 X 2.6																																																																																																																																																																																																																
W67	1.5 X 2.6																																																																																																																																																																																																																
W68	1.5 X 2.6																																																																																																																																																																																																																
W69	1.5 X 2.6																																																																																																																																																																																																																
W70	1.5 X 2.6																																																																																																																																																																																																																
W71	1.5 X 2.6																																																																																																																																																																																																																
W72	1.5 X 2.6																																																																																																																																																																																																																
W73	1.5 X 2.6																																																																																																																																																																																																																
W74	1.5 X 2.6																																																																																																																																																																																																																
W75	1.5 X 2.6																																																																																																																																																																																																																
W76	1.5 X 2.6																																																																																																																																																																																																																
W77	1.5 X 2.6																																																																																																																																																																																																																
W78	1.5 X 2.6																																																																																																																																																																																																																
W79	1.5 X 2.6																																																																																																																																																																																																																
W80	1.5 X 2.6																																																																																																																																																																																																																
W81	1.5 X 2.6																																																																																																																																																																																																																
W82	1.5 X 2.6																																																																																																																																																																																																																
W83	1.5 X 2.6																																																																																																																																																																																																																
W84	1.5 X 2.6																																																																																																																																																																																																																
W85	1.5 X 2.6																																																																																																																																																																																																																
W86	1.5 X 2.6																																																																																																																																																																																																																
W87	1.5 X 2.6																																																																																																																																																																																																																
W88	1.5 X 2.6																																																																																																																																																																																																																
W89	1.5 X 2.6																																																																																																																																																																																																																
W90	1.5 X 2.6																																																																																																																																																																																																																
W91	1.5 X 2.6																																																																																																																																																																																																																
W92	1.5 X 2.6																																																																																																																																																																																																																
W93	1.5 X 2.6																																																																																																																																																																																																																
W94	1.5 X 2.6																																																																																																																																																																																																																
W95	1.5 X 2.6																																																																																																																																																																																																																
W96	1.5 X 2.6																																																																																																																																																																																																																
W97	1.5 X 2.6																																																																																																																																																																																																																
W98	1.5 X 2.6																																																																																																																																																																																																																
W99	1.5 X 2.6																																																																																																																																																																																																																
W100	1.5 X 2.6																																																																																																																																																																																																																
<p>ISSUED FOR APPROVAL</p>																																																																																																																																																																																																																	
<p>STAMP:</p>																																																																																																																																																																																																																	
<p>APPROVAL/DRAWING</p>																																																																																																																																																																																																																	
<p>Checked by: _____</p>																																																																																																																																																																																																																	
<p>Checked by: _____</p>																																																																																																																																																																																																																	
<p>PROJECT : EXISTING PLAN OF MAHAJALAS COLLEGE, UNIVERSITY OF MYSORE</p>																																																																																																																																																																																																																	
<p>CLIENT : UNIVERSITY OF MYSORE</p>																																																																																																																																																																																																																	
<p>DRAWING TITLE</p>																																																																																																																																																																																																																	
<p>FIRST FLOOR PLAN</p>																																																																																																																																																																																																																	
<p>DRAWING - EXISTING PLAN</p>																																																																																																																																																																																																																	
<p>DATE : 2024</p>																																																																																																																																																																																																																	
<p>SCALE : 1/50</p>																																																																																																																																																																																																																	
<p>DESIGNED BY: ANISH</p>																																																																																																																																																																																																																	
<p>ARCHITECTURE</p>																																																																																																																																																																																																																	
<p>ARISH M SWAMIT CONSULTANTS</p>																																																																																																																																																																																																																	
<p>Committee, Architectural and Structural Engineers</p>																																																																																																																																																																																																																	
<p>100 Bg Bazaar, Mysore - 570002</p>																																																																																																																																																																																																																	
<p>Phone: 98453 22222</p>																																																																																																																																																																																																																	
<p>www.arishm.com</p>																																																																																																																																																																																																																	

2.1.5

### Academic Calendar

Sl.No	Particular	Dates for 2018-19
1.	Admission	June-July
2.	Commencement of Academic Session for III and V Semester students	Mid-June
3.	Orientation and P.D.P. for Fresher Students	Last week of July
4.	Release of "Ananthayathri" Annual College Magazine	First week of August
5.	Annual Talent Search and Extra-Curricular activities Inaugural	Second week of August
6.	Inter-zonal Sports Meet for Men	Second week of September
7.	Centralised Internal assessment College Tests for Odd Semesters	Mid October
8.	Celebration of Karnataka Rajyothsava	First week of November
9.	Odd Semester Examinations	November – December
10.	Inter Collegiate Padmaja Prasad Memorial Music Competition	Mid January
11.	College level Dr. Rajkumar Memorial Music Competition	Mid January
12.	Centralised Internal Assessment Tests for Even Semesters	Last week of March
13.	Dr.B.R.Ambedkar Jayanthi celebration	Second week of April
14.	Valedictory Function/College Day	Last week of April
15.	Farewell to outgoing students	Last week of April
16.	Even Semester Examinations	May-June
17.	Educational Trips for Students	February to April
18.	One-day picnic for Staff	Second week of August and last week of January



